



# Welcome to the ALUMAT System

Patented door transitions for increased living comfort

- Threshold-free double seals
- Door threshold profiles
- Door renovation profiles
- Sealing strip for windows and doors

Version May 2023 · subject to technical changes

**Latest awards:** Universal Design Competition 2022.



Universal Design Gold, Expert and Consumer Award 2022 for **threshold type MFZ**: „Türrenovierungsprofil mit Magnet-Dichtungen für energieeffizientes Sanieren“

Also for **threshold type MFAT PH** Alumat got two awards at Universal Design Award 2022.

Previous awards:



Detailed documentation and installation guidelines can be found on our homepage [www.alumat.de](http://www.alumat.de)



	Page
Magnet double seals for house, patio and balcony doors	
<b>New construction profiles</b>	4 – 9
Auxiliary profiles for type MFAT/MFAT PH	10 – 11
Constructional sealing for type MFAT PH	12 – 13
Magnet comfort threshold MHT for house doors	14 – 17
Magnet double seals for patio and balcony doors	
<b>Renovation profiles</b>	18 – 21
Flat threshold for lift-and-slide doors · <b>Renovation profiles</b>	22 – 23
Flat threshold for lift-and-slide doors · <b>New construction profiles</b>	24 – 25
Auxiliary profiles for lift-and-slide doors – flat threshold type HST 10/2 or 20/2	26
Magnet door seals for interior doors	27 – 29
Door threshold profiles for interior doors	30 – 32
Door renovation profiles for interior doors	33
Sealing strip for windows and doors	34
Overview of system-dependent seals for MFAT/MFZ	35
About us	36

Photo: Alumat Frey GmbH

Photo: © multivisualart 2018





## For wooden exterior doors (wood-aluminum)

Also for energy  
efficient houses

- 1 Aluminum weatherboard with profile cover surface in choice of EV1 silver, anthracite RAL 7016, bronze C33, white RAL 9016 or plain.
- 2 Plastic magnet holder profile 7 x 43 mm (brown or white). Interior magnet guide is parallel to the hardware groove.
- 3 Upper magnet seal profiles with insulation and double adhesive tape (3 x 17 mm). An additional fixture is recommended for fastening the upper magnets permanently.
- 4 Adjustable silicone slide seal in the weatherboard with threaded pins 5 x 6 mm for invisible fastening with threaded holes. Seal base with permanent connection in the aluminum holder profile.
- 5 Highly insulating zero threshold as composite profile with integrated drainage. A PVC cover is included for protection against construction dirt. **Floor recess 71 mm (alternative 50 mm).**
- 6 Water chamber with 17 mm drainage holes (three variants: 76, 82 or 88 - will be delivered factory-fitted depending on the installation depth). **Can replace channel system.**
- 7 Water outlet for on-site hose connection 3/4 inch, with self-tapping stainless steel screws 4.2 x 19 mm **for on-site installation.** Standard: straight, alternatively: bent.
- 8 For an additional charge: Sealing membrane welded on at the factory (Wolfen). Connection bitumen compatible or material identical to the seal material.
- 9 Load-bearing thermal insulation for threshold foundation (material: PET). Standard height: 2 x 50 mm included. Auxiliary profiles 30, 40 and 50 mm for higher floor structure available for additional charge.
- 10 Groove additional TPE seal (groove 5 x 13 mm) before painting, in order to restore the circumferential seal level (glue seal if necessary). Mount seal lip flush with the frame inner edge.
- 11 Two lower magnet seal profiles (9 x 15 mm). Nose always points to the outside. Standard 2-feet with 43 dB, alternatively 3-feet with 46 dB sound insulation.

Scope of delivery and calculation in fixed lengths (no cuts).  
Dimensional specifications = decorative frame outer dimensions including fixed glazing side parts (up to max. 6000 mm length).

**Available for additional charge:** patio seal on the magnet double seal, preassembled at the factory taking into account the technical regulations with provided sealing (150 mm) on the masonry, consisting of: composite sheet metal profiles and welded-on sealing membrane flag WOLFEN, d = 1.5 mm, membrane width approx. 550 mm, and two loose included outside corners.

Other plastic sealing membranes, e.g. PVC-pnb, EVA-PVC, FPO/TPO, chlorinated polyethylene, EPDM-based are possible on site.

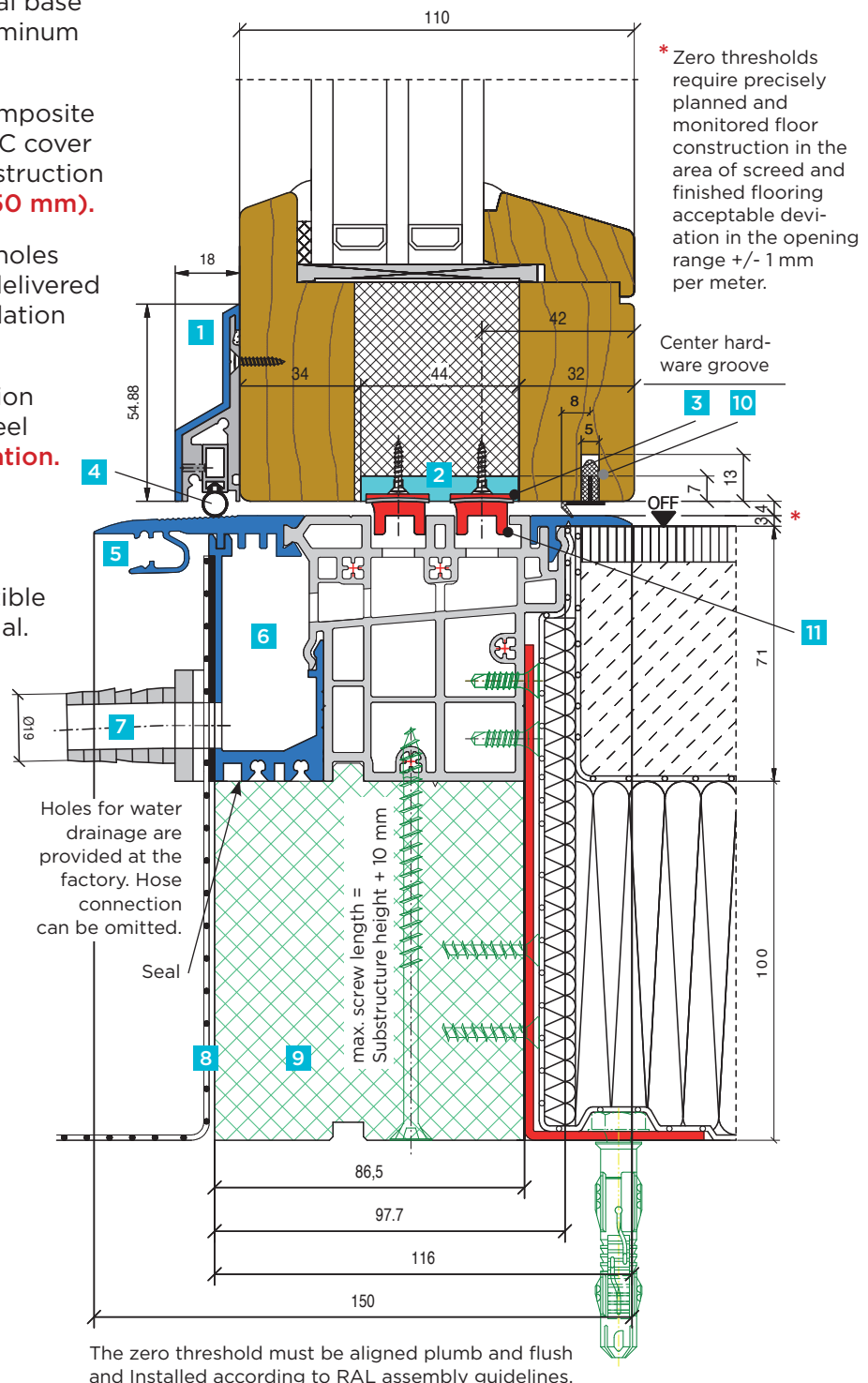



Also for energy  
efficient houses

For **inward-opening** elements ·  
with **short** interior sill.

For **outward-opening** elements from approx.  
76 mm decorative frame thickness ·  
with **extended** interior sill

## MFAT 10 PH

Standard design with **71 mm** floor recess

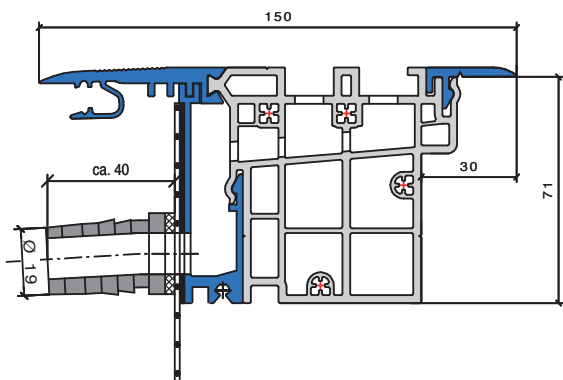

## MFAT 10/a PH

with **71 mm** floor recess

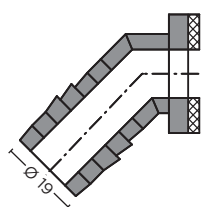
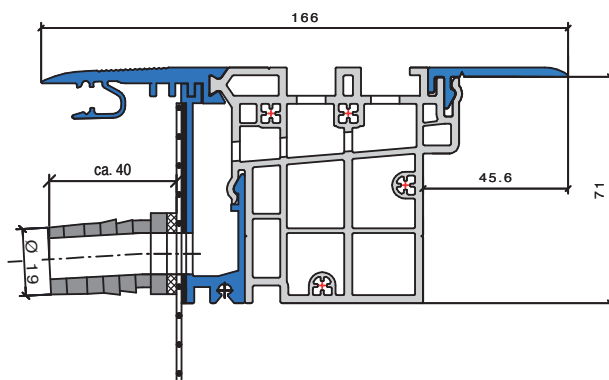

All profiles  
also available  
with curved  
water drainage  
connectors

## MFAT 10/2 PH

with **50 mm** floor recess

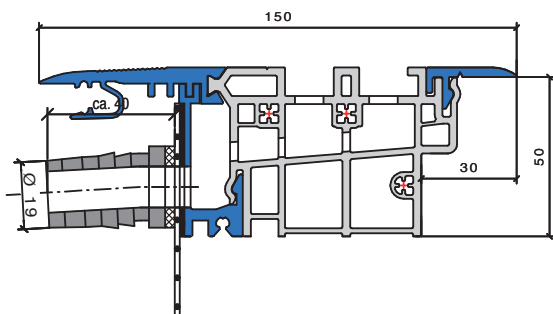

## MFAT 10/2a PH

with **50 mm** floor recess

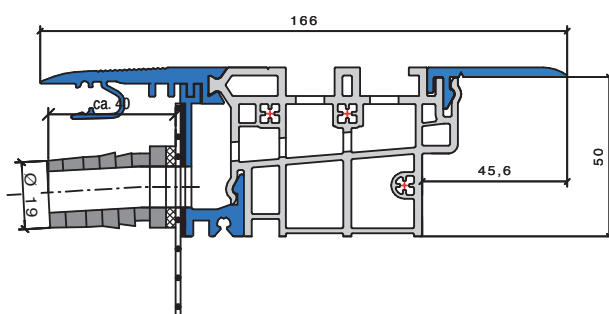

## VARIABLE WATER CHAMBERS

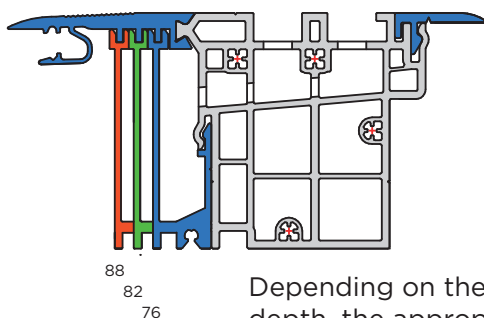

Depending on the installation  
depth, the appropriate water  
chamber (76, 82 or 88) is  
delivered from the factory.

Notched both-sided  
(additional charge).

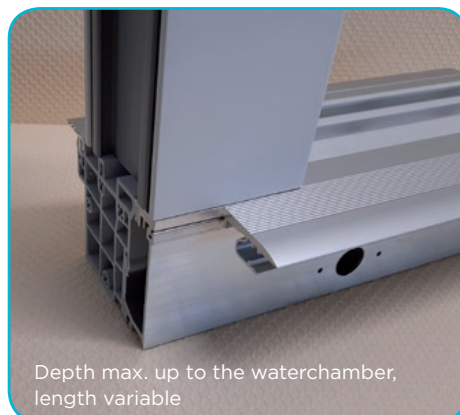

Depth max. up to the waterchamber,  
length variable

## For plastic and aluminum exterior doors

Also for energy  
efficient houses

- 1 Aluminum weatherboard with profile cover surface in choice of EV1 silver, anthracite RAL 7016, bronze C33, white RAL 9016 or plain.
- 2 Plastic magnet holder profile, white, factory-fitted to width and prefabricated to sash rebate dimension upon request. Interior magnet guide is parallel to the hardware groove.
- 3 Upper magnet seal profiles with insulation and double adhesive tape (3 x 17 mm). Upon entering the FFM, the upper magnets are permanently mounted at the factory.
- 4 Adjustable silicone slide seal in the weatherboard with threaded pins 5 x 6 mm for invisible fastening with threaded holes. Seal base with permanent connection in the aluminum holder profile.
- 5 Highly insulating zero threshold with integrated drainage. A PVC cover is included for protection against construction dirt.  
**Floor recess 71 mm (alternative 50 mm).**
- 6 Water chamber with 17 mm drainage holes (three variants: 76, 82 or 88 – will be delivered factory-fitted depending on the installation depth). **Can replace channel system.**
- 7 Water outlet for on-site hose connection 3/4 inch, with self-tapping stainless steel screws 4.2 x 19 mm **for on-site installation.** Standard: straight, alternatively: bent.
- 8 For an additional charge: Sealing membrane welded on at the factory (Wolfen). Connection bitumen compatible or material identical to the seal material
- 9 Load-bearing thermal insulation for threshold foundation (material: PET). Standard height: 2 x 50 mm included. Auxiliary profiles 30, 40 and 50 mm for higher floor structure available for additional charge.
- 10 Additional TPE seal, so that the circumferential sealing level is restored to the same as the doorstop (system dependent).
- 11 Two lower magnet seal profiles (9 x 15 mm). Nose always points to the outside. Standard 2-feet with 43 dB, alternatively 3-feet with 46 dB sound insulation.

Scope of delivery and calculation in fixed lengths (no cuts).  
Dimensional specifications = decorative frame outer dimensions including fixed glazing side parts (up to max. 6000 mm length).

**Available for additional charge:** patio seal on the magnet double seal, preassembled at the factory taking into account the technical regulations with provided sealing (150 mm) on the masonry, consisting of: composite sheet metal profiles and welded-on sealing membrane flag WOLFIN, d = 1.5 mm, membrane width approx. 550 mm, and two loose included outside corners.

Other plastic sealing membranes, e.g. PVC-pnb, EVA-PVC, FPO/TPO, chlorinated polyethylene, EPDM-based are possible on site.

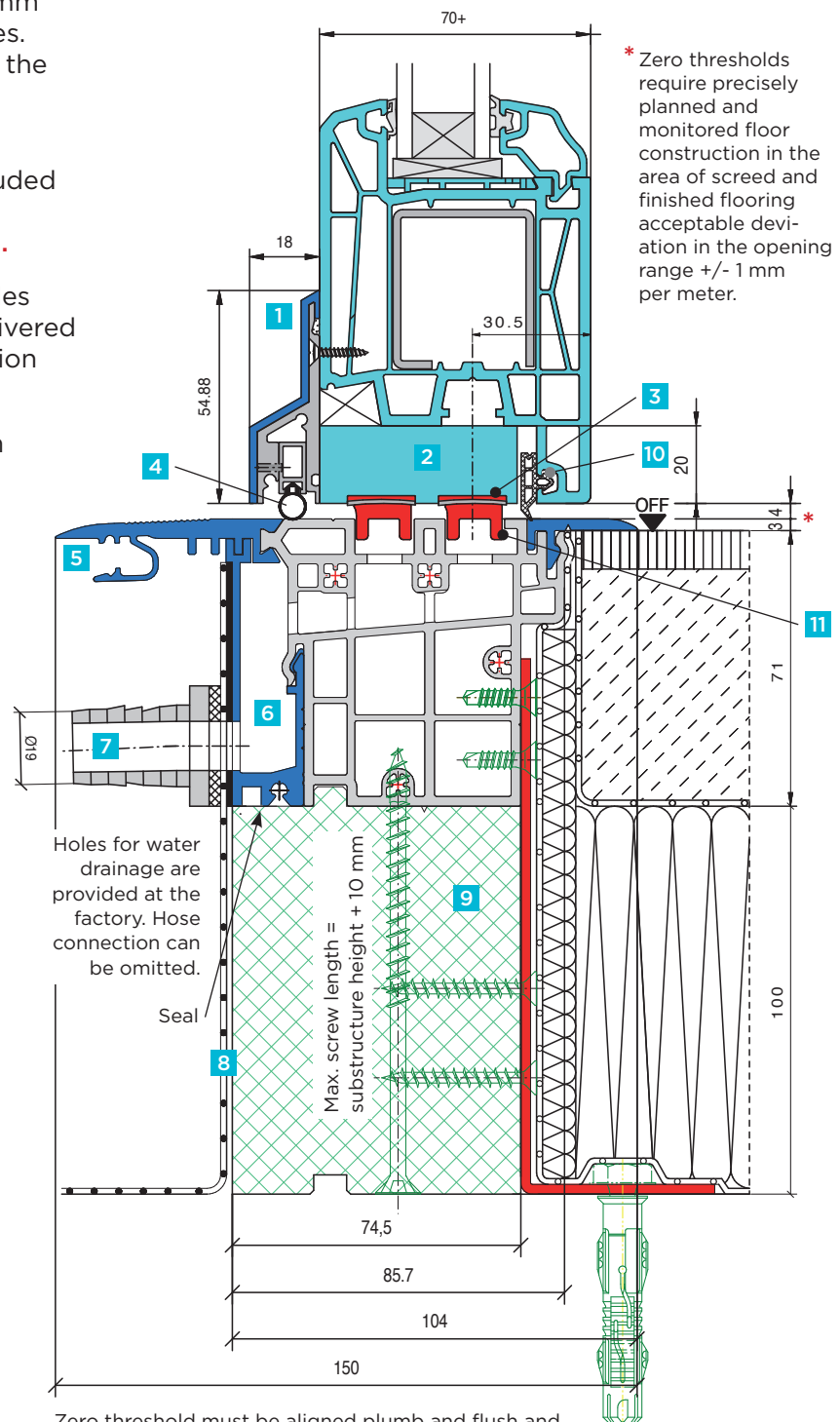

Zero threshold must be aligned plumb and flush and mounted according to the RAL assembly guidelines.

Also for energy efficient houses

For **inward-opening** elements ·  
with **short** interior sill.

For **outward-opening** elements from approx.  
76 mm decorative frame thickness ·  
with **extended** interior sill

## MFAT 20 PH

Standard design with **71 mm** floor recess

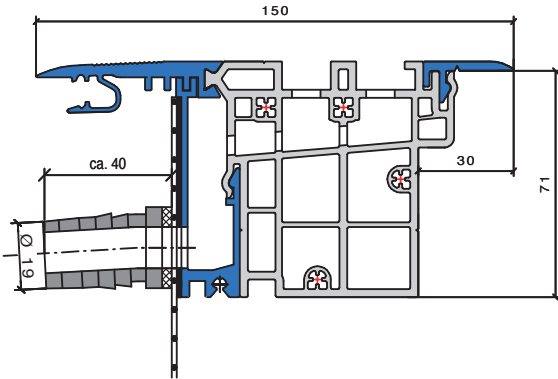

## MFAT 20/a PH

with **71 mm** floor recess

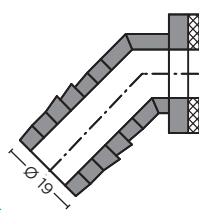
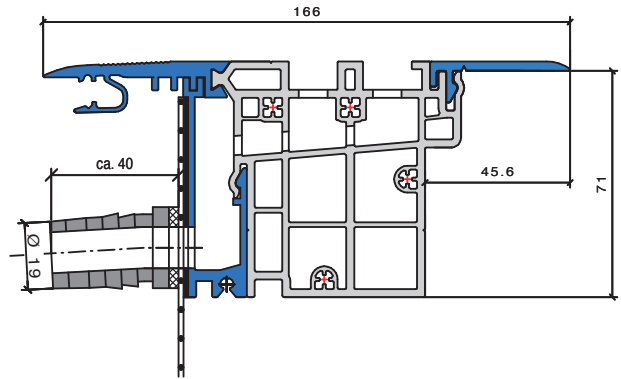

All profiles  
also available  
with curved  
water drainage  
connectors

## MFAT 20/2 PH

with **50 mm** floor recess

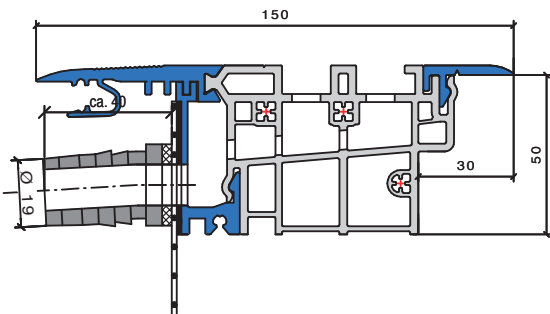

## MFAT 20/2a PH

with **50 mm** floor recess

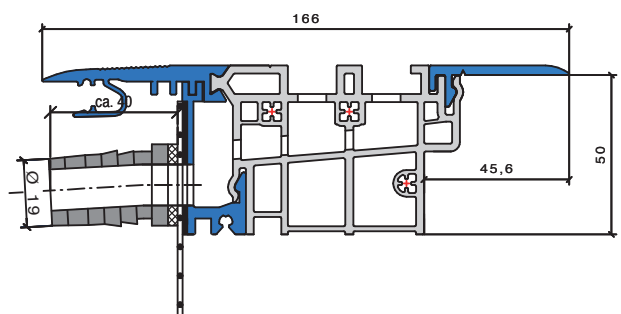

## VARIABLE WATER CHAMBERS

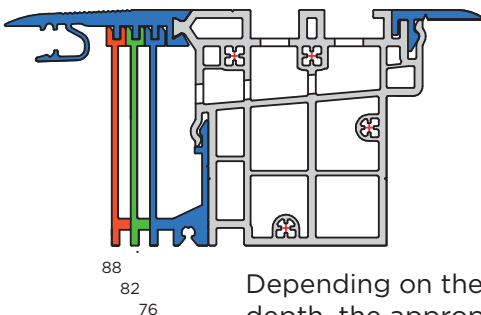

Depending on the installation  
depth, the appropriate water  
chamber (76, 82 or 88) is  
delivered from the factory.

Notched both-sided  
(additional charge).

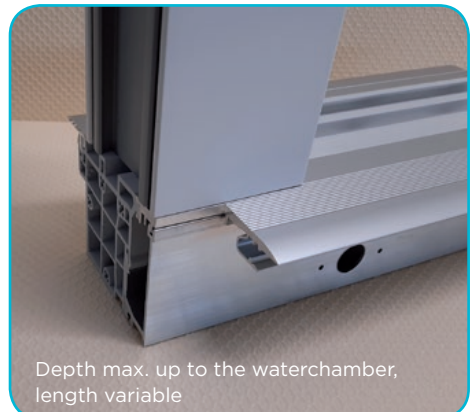

Depth max. up to the waterchamber,  
length variable



- 1 Aluminum weatherboard with profile cover surface in choice of EV1 silver, anthracite RAL 7016, bronze C33, white RAL 9016 or plain.
- 2 Plastic magnet holder profile, white, factory-fitted to width and prefabricated to sash rebate dimension upon request. Interior magnet guide is parallel to the hardware groove.
- 3 Upper magnet seal profiles with insulation and double adhesive tape (3 x 17 mm). Upon entering the FFM, the upper magnets are permanently mounted at the factory.
- 4 Adjustable silicone slide seal in the weatherboard with threaded pins 5 x 6 mm for invisible fastening with threaded holes. Seal base with permanent connection in the aluminum holder profile.
- 5 Highly insulating zero threshold with integrated drainage. A PVC cover is included for protection against construction dirt. **Floor recess 71 mm** (alternative 50 mm).
- 6 Water chamber with 17 mm drainage holes (three variants: 76, 82 or 88 – will be delivered factory-fitted depending on the installation depth). **Can replace channel system.**
- 7 Water outlet for on-site hose connection incl. self-tapping stainless steel screws 4.2 x 19 mm **for on-site installation**. Standard: straight, alternatively: bent.
- 8 For an additional charge: Sealing membrane welded on at the factory (Wolfen). Connection bitumen compatible or material identical to the seal material.
- 9 Load-bearing thermal insulation for threshold foundation (material: PET). Standard height: 2 x 50 mm included. Auxiliary profiles 30, 40 and 50 mm for higher floor structure available for additional charge.
- 10 Additional TPE seal, so that the circumferential sealing level is restored to the same as the doorstop (system dependent).
- 11 Two lower magnet seal profiles (9 x 15 mm). Nose always points to the outside. Standard 2-feet with 43 dB, alternatively 3-feet with 46 dB sound insulation.

Scope of delivery and calculation in fixed lengths (no cuts).

Dimensional specifications = decorative frame outer dimensions including fixed glazing side parts (up to max. 6000 mm length).

**Available for additional charge:** patio seal on the magnet double seal, preassembled at the factory taking into account the technical regulations with provided sealing (150 mm) on the masonry, consisting of: composite sheet metal profiles and welded-on sealing membrane flag WOLFEN, d = 1.5 mm, membrane width approx. 550 mm, and two loose included outside corners.

Other plastic sealing membranes, e.g. PVC-pnb, EVA-PVC, FPO/TPO, chlorinated polyethylene, EPDM-based are possible on site.

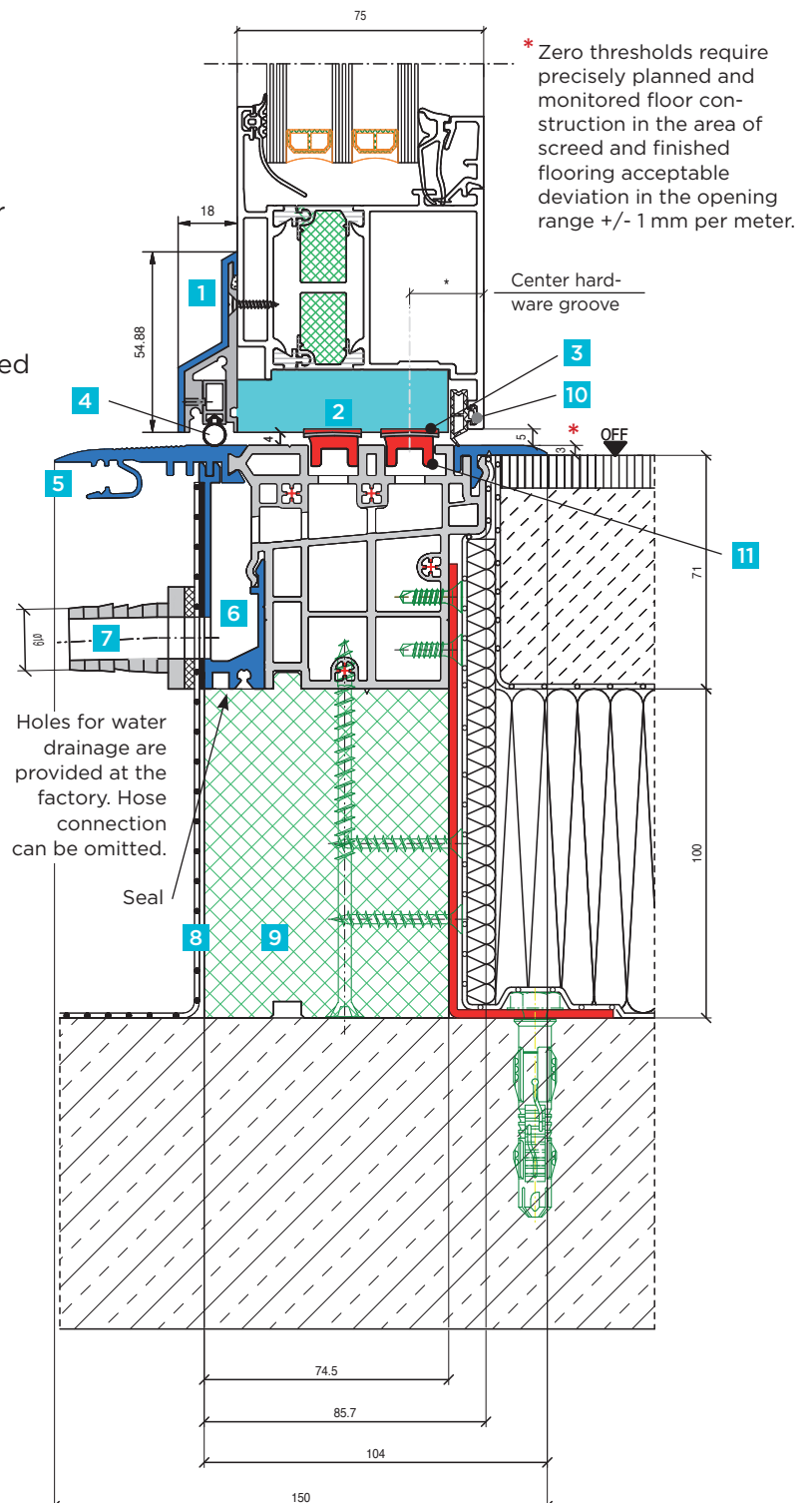

For **inward-opening** elements  
with **short** interior sill.

### MFAT 20 PH

Standard design with **71 mm** floor recess

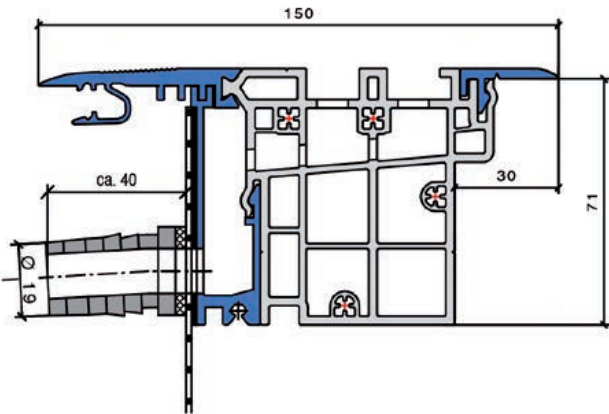

For outward-opening aluminum doors the short inner flap is usually sufficient (see left).

If not, see the extended interior sill on page 7 for MFAT 20 / a PH or MFAT 20 / 2a PH.

### MFAT 20/2 PH

with **50 mm** floor recess

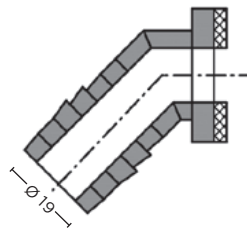
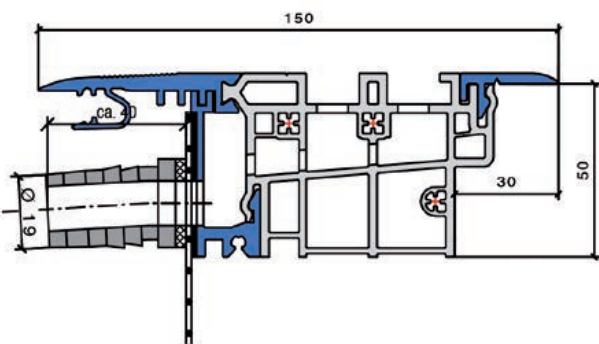

All profiles  
also available  
with curved  
water drainage  
connectors

### Base profile for aluminum doors

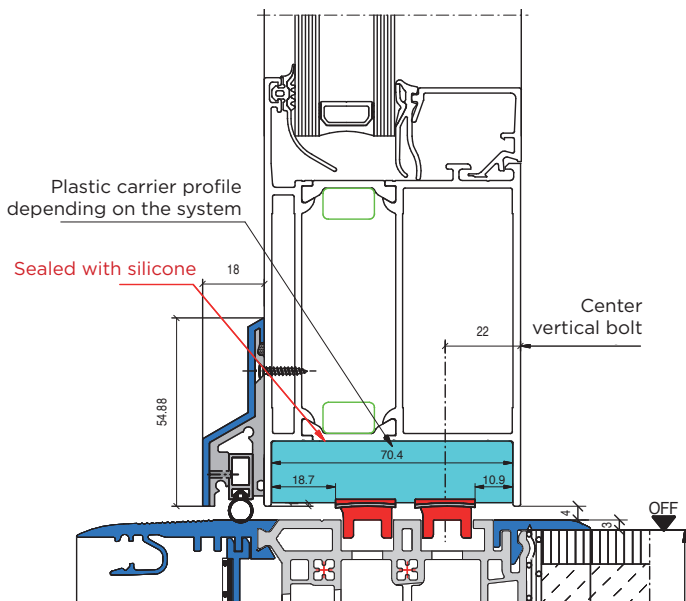

### Sash profile for aluminum doors

Upper magnetic carrier  
optionally in anthracite or white

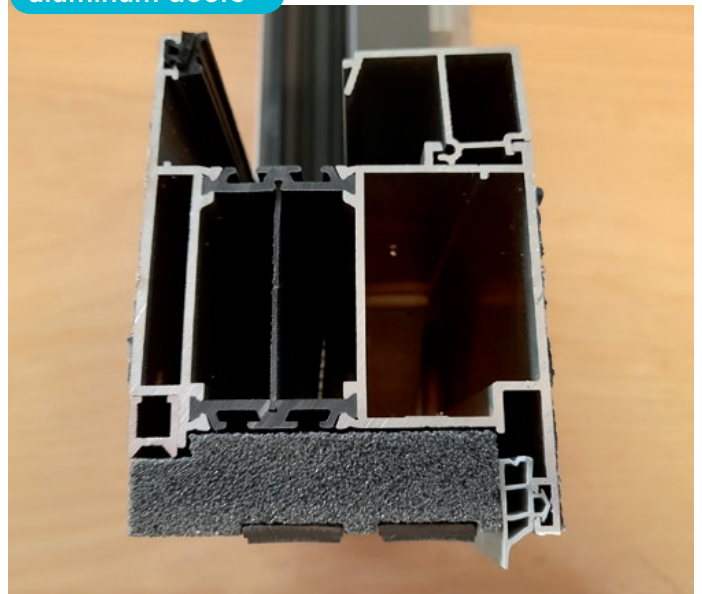

## Aluminum bridging profile to cover the thermal insulation composite system:

Lowering safe, same level and light in magnet zero threshold clip-on aluminum bridging profile (corrugated plate for covering the thermal insulation composite system).



Variable adaptation option from 85 to 250 mm with swiveling coupling option fitting prefabricated system with sustainable, fall-safe and inclusive transition between zero threshold and exterior covering for all users.

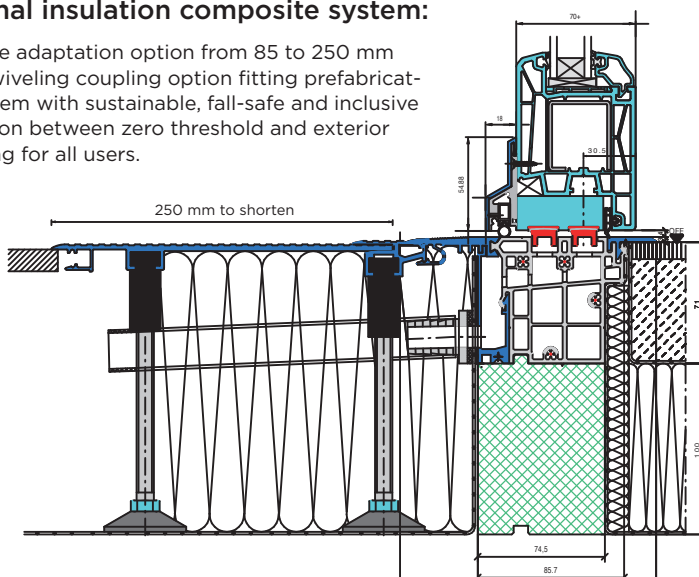

## ALU channel frame with grates

The channel frame from ALUMAT simplifies the installation via the clip-on function and prevents a subsequent lowering of the grate. This profile can either can be clipped-on in the bridging profile or directly in the magnet double seal (120 or 170 mm installation depth).

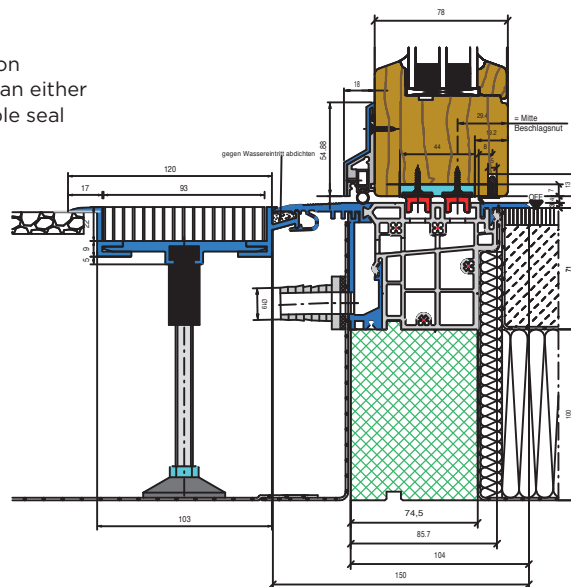
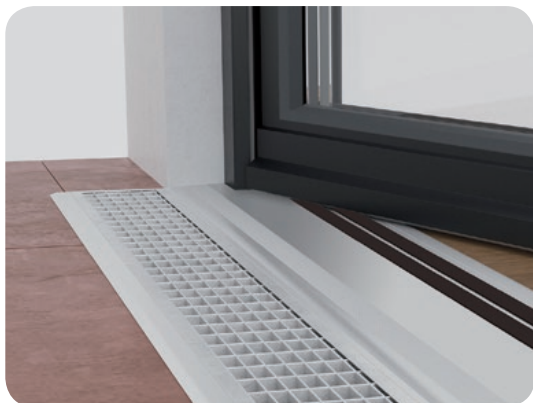

## Especially for entrance doors: Doormat

Black rubber (standard 600 x 400 mm), incl. clip-on aluminum dirt collection pan with drainage device.



Alternative with clip-in aluminum frame.

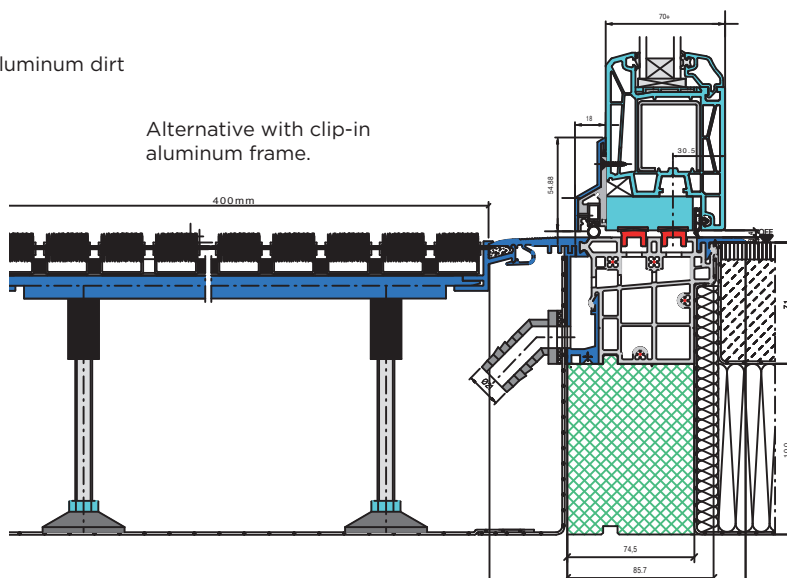



Short weatherboard for screwing on incl. aluminum cover for wooden or wood/aluminum doors or for half-stepped plastic doors

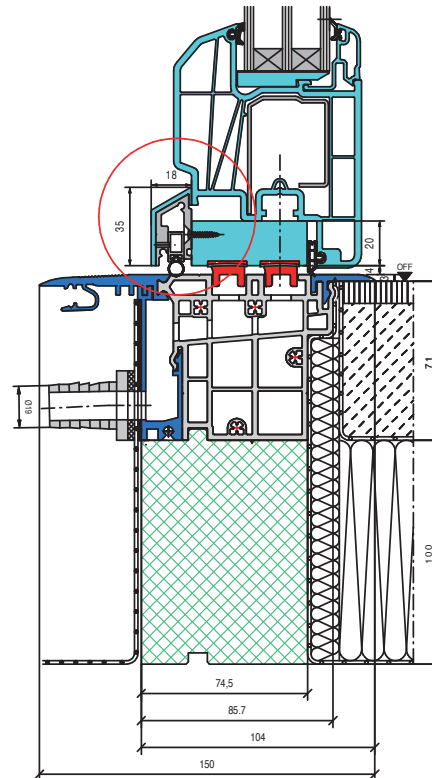
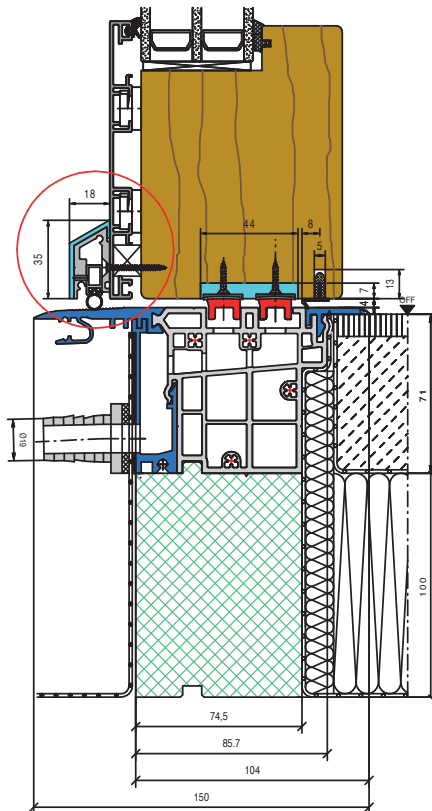

Aluminum cover profile impact interior and exterior in case two zero thresholds are coupled or for covering traces of use.

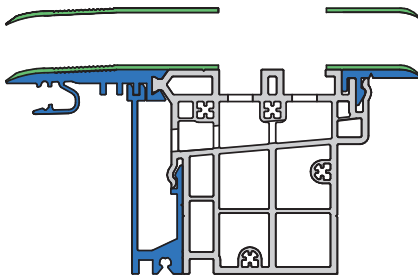

PVC cover profile against construction dirt

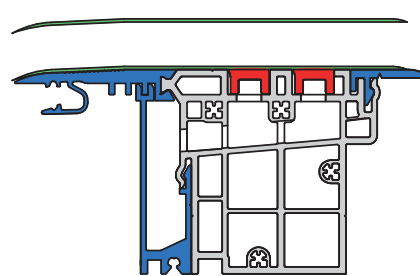

## Extension profile

Extension of the outer sill by 39 mm (e.g. for roller shutter guide rail)

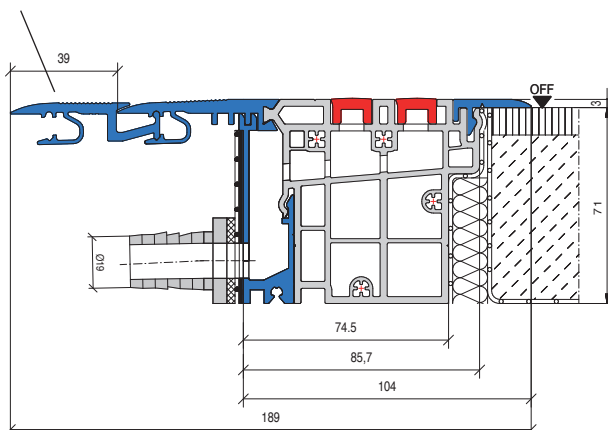

## Aluminum prefix profile for fixed glazing

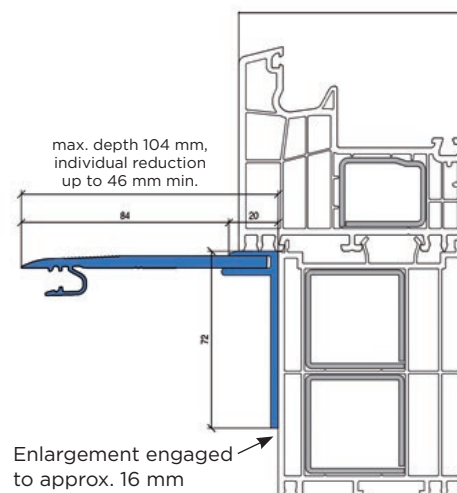

**Factor applied threshold seal and processing**  
in compliance with the flat roof guidelines  
and DIN 18531/18533.

Patio sealing on the magnet double seal  
preassembled at the factory with intended  
sealing (150 mm) to the masonry  
(available at additional cost).

- a** Plastic retaining plates with sealing, pre-drilled and slotted.
- b** Sealing membrane flag, welded at the factory with compound sheet metal (corner bracket **c**). Standard WOLFIN.
- d** Aluminum floor profile.
- e** Sealing membrane, water-proof glued to the pre-bored water chamber using compound sheet metal.
- f** Water drainage hoses  $\frac{3}{4}$  inch with 1 meter drainage pipe integrated in the gravel bed or in the drainage system. For overlap doors double design (available for additional cost).

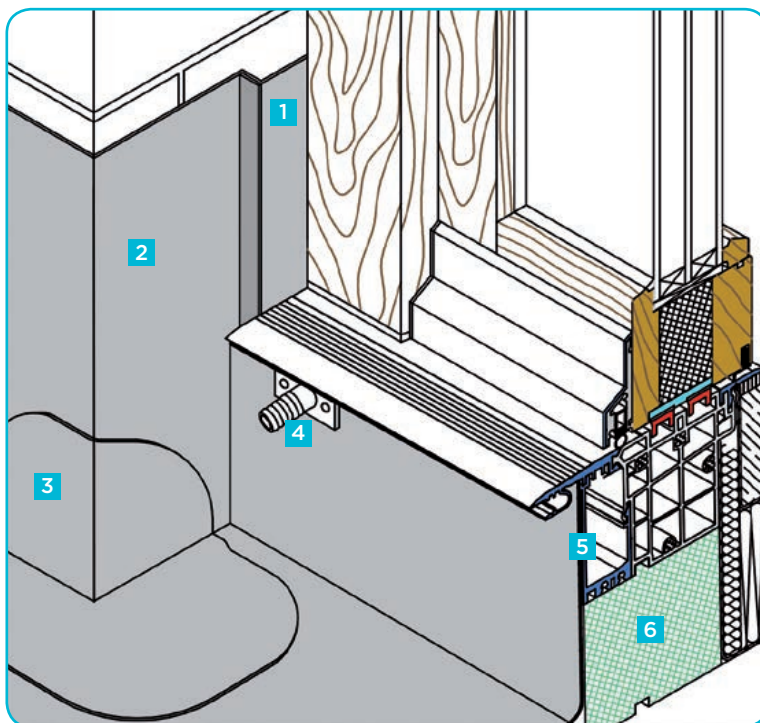
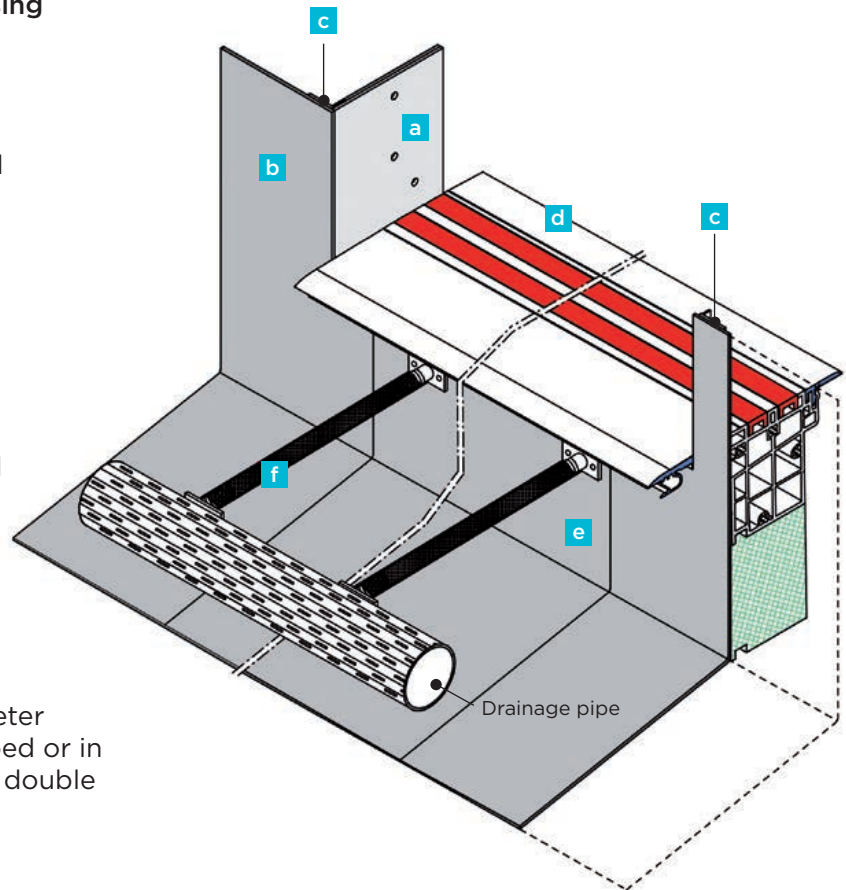

- 1** Compound sheet metal (corner bracket) welded with sealing membrane.
- 2** Sealing membrane flag,  $d = 1.5$  mm, membrane width approx. 550 mm, standard WOLFIN.
- 3** The inner and outer corners, which are charged additionally, must be integrated professionally and appropriately by the sealing company.
- 4** Water drainage opening with hose connection On site introduction with plastic hose optionally in channel, in drainage system, in gutter, in downspout or in gravel bed using ALUMAT drainage pipe **f**.
- 5** Compound steel sheet, glued waterproof at factory with water chamber and welded at the factory with sealing membrane flag.
- 6** Load-absorbing thermal insulation for threshold foundation made of PET.

Zero thresholds are the rule in accordance with the standard for barrier-free construction and according to the standard for waterproofing of buildings. The magnetic zero threshold and the industrially prefabricated waterproofing of the buildings meet the requirements of DIN 18040, DIN 18531/18533 and the Flat Roof Directive. The normative and building regulations must be taken into account in accordance with the respective installation conditions.



Liquid sealing for zero thresholds MFAT 10 and 20 PH

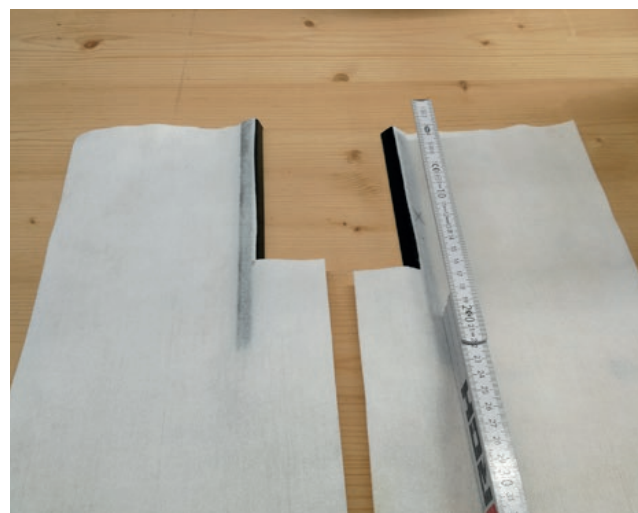
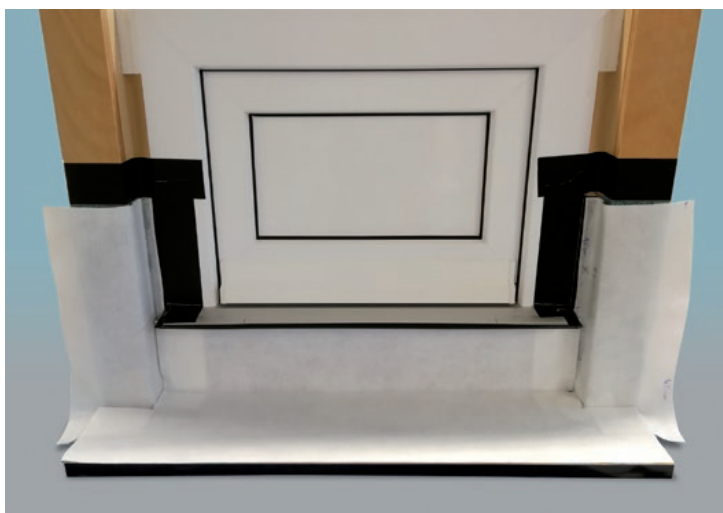

**Sealing set for liquid plastic consists of:**

1 pair of fleece corner posts (525 x 700 mm)  
Density of 165 g/m<sup>2</sup> mounted on composite sheet  
metal angle for lateral sealing on masonry (150 mm  
over OKFF) + fleece loose 525 mm wide, length  
matching the zero threshold.

**Very special - factory-prepared connections without joint widths**

The industrially prefabricated constructional seals of magnet zero threshold allow for the vertical connection without joint widths – regardless of whether with sealing membranes or with liquid plastic, the sealing membrane or the carrier profiles for liquid plastic must be clipped into a prepared connection only on the construction site – a time-consuming gluing of sealing tapes and planning for otherwise necessary joint widths of 3-5 is not required!

Current approval for:



**KEMPEROL**

**Triflex**  
Gemeinsam gelöst.



- 1 Aluminum base profile EV1 anodized with PVC center section and drainage slots.
- 2 One upper magnet seal profile with insulation and double adhesive tape (3 x 17 mm). For positioning, mill a groove with 2 x 17.5 mm in leaf underside. An additional fixture is recommended for fastening permanently.
- 3 One lower magnet seal profile (9 x 15 mm), **always insert with the nose pointing to the outside.**
- 4 Mill two grooves for fixing both TPE seals (groove 5 x 13 mm) inside and outside before painting. When using our aluminum weather-board (available for additional charge), one TPE seal is sufficient. To again make a circumferential sealing level, the sealing lip should be placed in the same level as the already existing stop seal.

## MHT 10/1

With lower lying exterior covering, the leveling to the ALUMAT floor profile can be done using elevated wood or plastic covering.

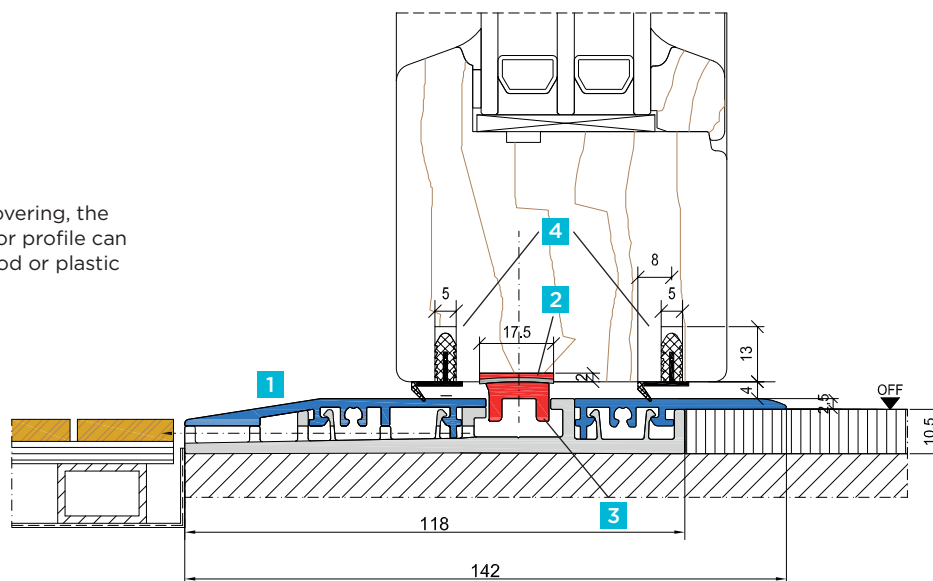

## MHT 10/2

Inside and outside same floor level

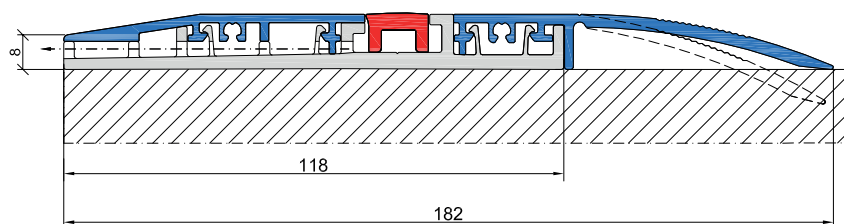

## MHT 10/3

Level differences from higher lying exterior covering of from 10 to 30 mm to the interior floor covering can be bridged with the adaptable inclined ramp.

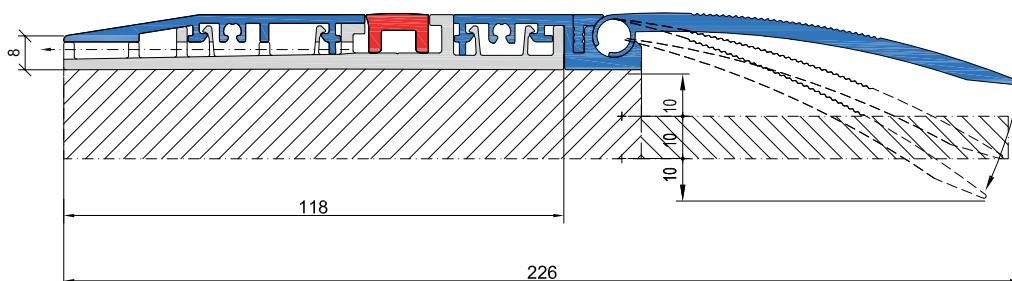

With integrated house doors in the existing construction, the present stop threshold must be removed. The barrier-free ALUMAT magnet comfort threshold must be fitted into the decorative frame rebate and **sealed on the side**. Either shorten or lengthen the doors with approx. 4 mm gap to the ALUMAT floor profile.

## MHT 10/1 with base profile

Comfort threshold for wood house doors  
(wood-aluminium) incl. threshold foundation  
113 x 25 mm (PET)

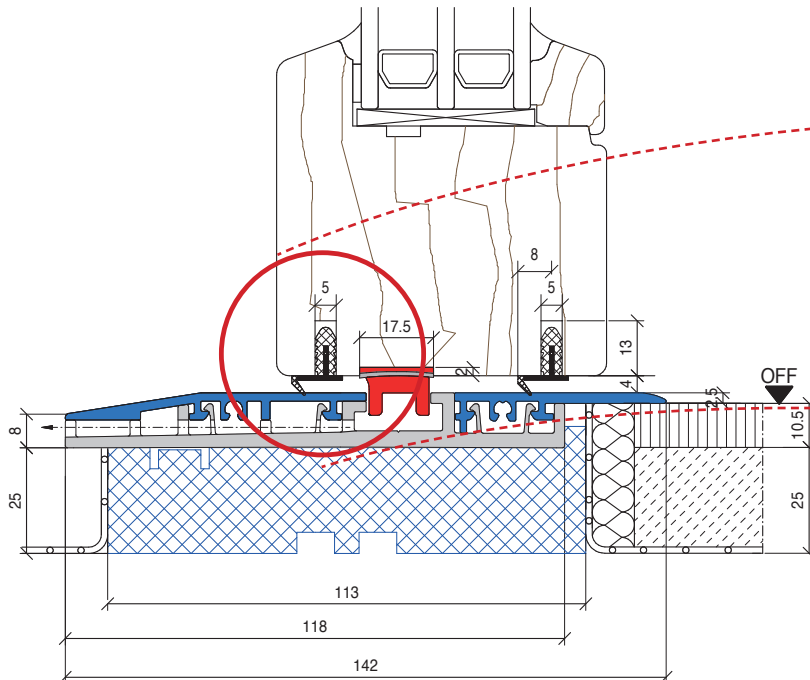

Alternative available for additional charge:

**Aluminum weatherboard** with profile cover and silicone slide seal. Surface selections EV 1 silver colored, bronze C33, white RAL 9016, anthracite RAL 7016 or bright

Comfort threshold for wood house doors (wood-aluminum) incl. threshold foundation 113 x 25 mm (PET) + additional foundation profile (30, 40, 50 mm high) positioned flush **outside**.

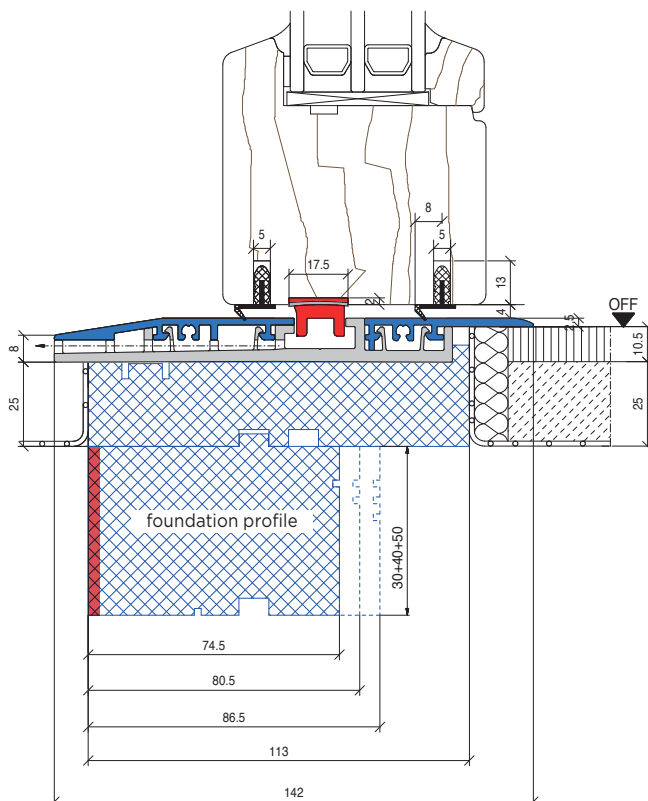

Additional foundation profile (30, 40, 50 mm high) positioned flush **inside**.

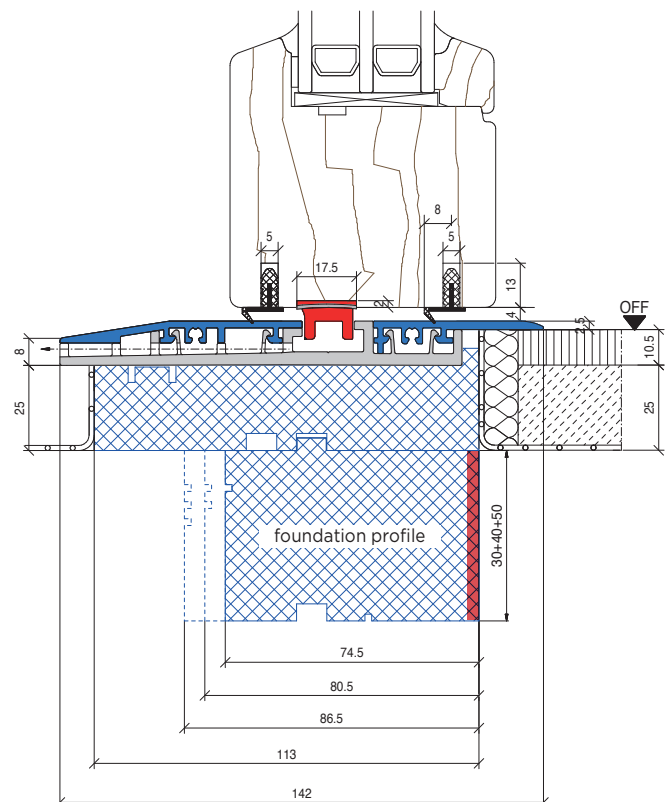

- 1 Aluminum base profile EV1 anodized with PVC center section and drainage slots.
- 2 One upper magnet seal profile with insulation and double adhesive tape (3 x 17 mm). An additional fixture is recommended for fastening permanently.
- 3 One lower magnet seal profile (9 x 15 mm), **always insert with the nose pointing to the outside**.
- 4 Additional TPE seal, so , that the circumferential sealing level is , restored to the same as the doorstep (profile related).
- 5 Plastic magnet profile, white or anthracite, adapted at the factory to the profile installation depth.
- 6 **Optional:** Aluminum weatherboard with profile cover incl. adjustable silicone slide seal in the weatherboard; 2 threaded pins 5 x 6 mm for invisible fastening; with threaded holes. Seal base with permanent connection in the aluminum holder profile. Surface selections EV1 silver, bronze C33, white RAL 9016, anthracite RAL 7016 or bright

## MHT 20/1

With lower lying exterior covering, the leveling to the ALUMAT floor profile can be done using elevated wood or plastic covering.

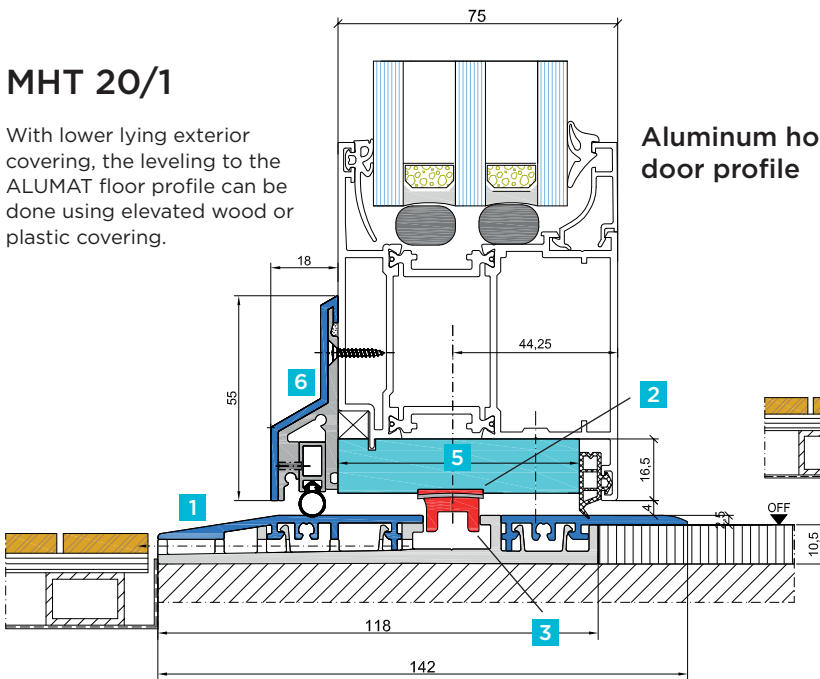

## Aluminum house door profile

## Plastic house door profile

sash covered without aluminum weatherboard

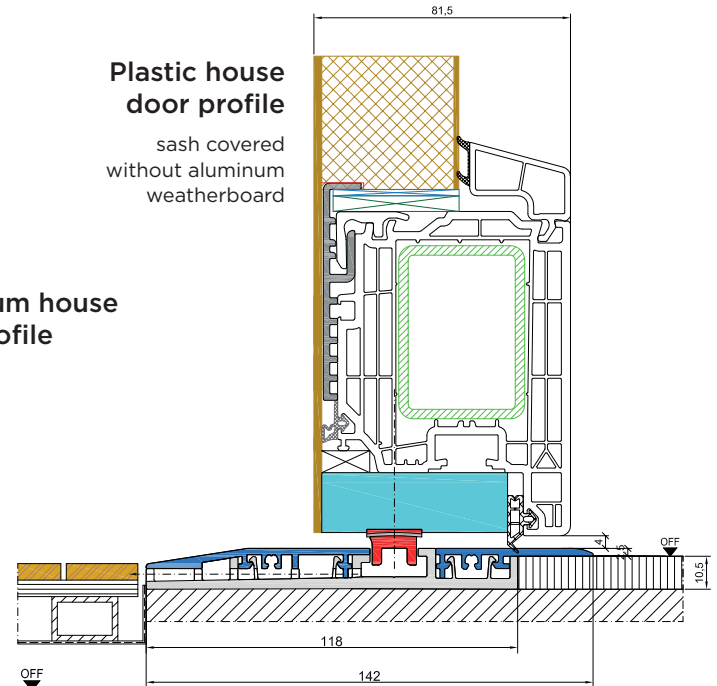

## MHT 20/2

Inside and outside same floor level

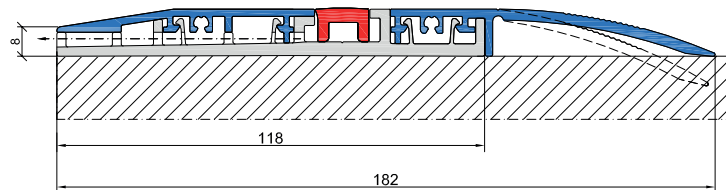

## MHT 20/3

Level differences from higher lying exterior covering of from 10 to 30 mm to the interior floor covering can be bridged with the adaptable inclined ramp.

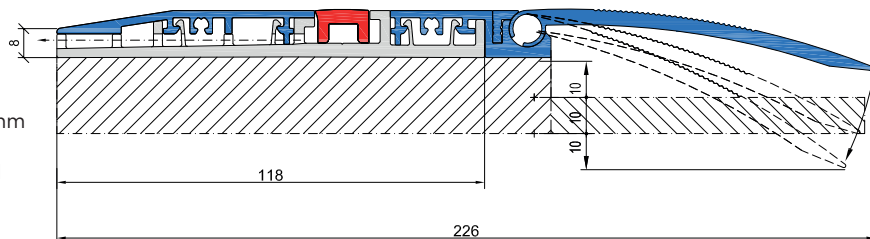

With integrated house doors in the existing construction, the present stop threshold must be removed. The barrier-free ALUMAT magnet comfort threshold must be fitted into the decorative frame rebate and **sealed on the side**. Either shorten or lengthen the doors with approx. 4 mm gap to the ALUMAT floor profile.



## MHT 20/1 with base profile

Comfort threshold for **aluminum house doors**  
incl. threshold foundation 113 x 25 mm (PET)

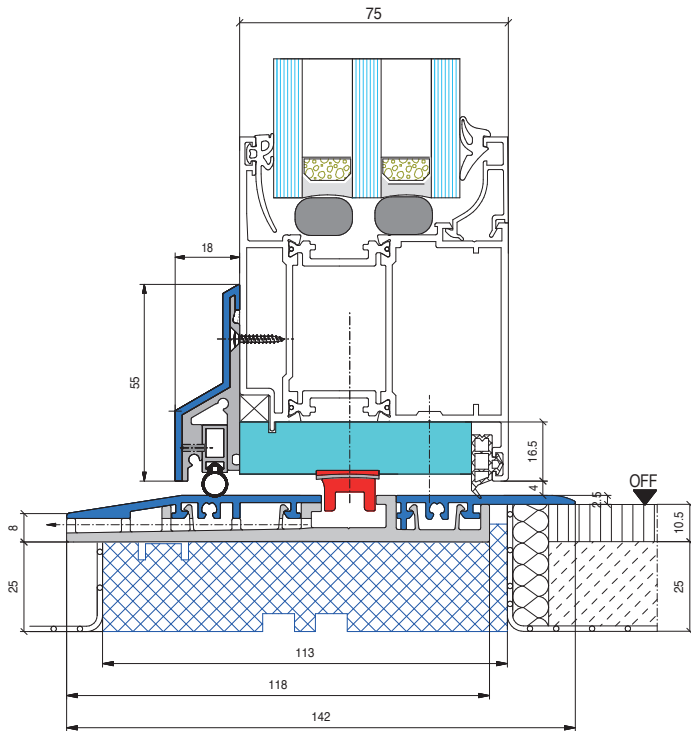

Comfort threshold for **plastic house doors**  
incl. threshold foundation 113 x 25 mm (PET)

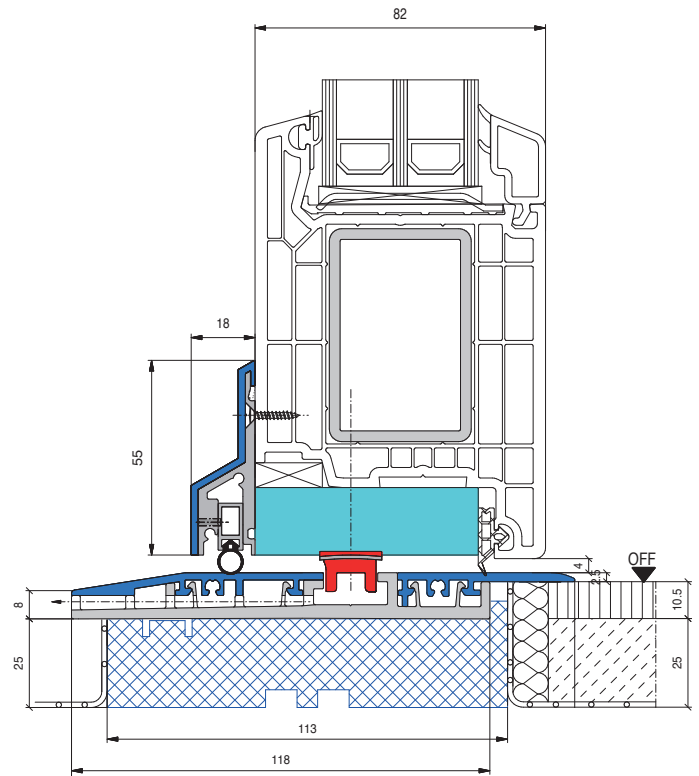

Comfort threshold for **aluminum house doors**  
incl. threshold foundation 113 x 25 mm (PET)  
+ additional foundation profile (30, 40, 50 mm  
high) positioned flush **outside**.

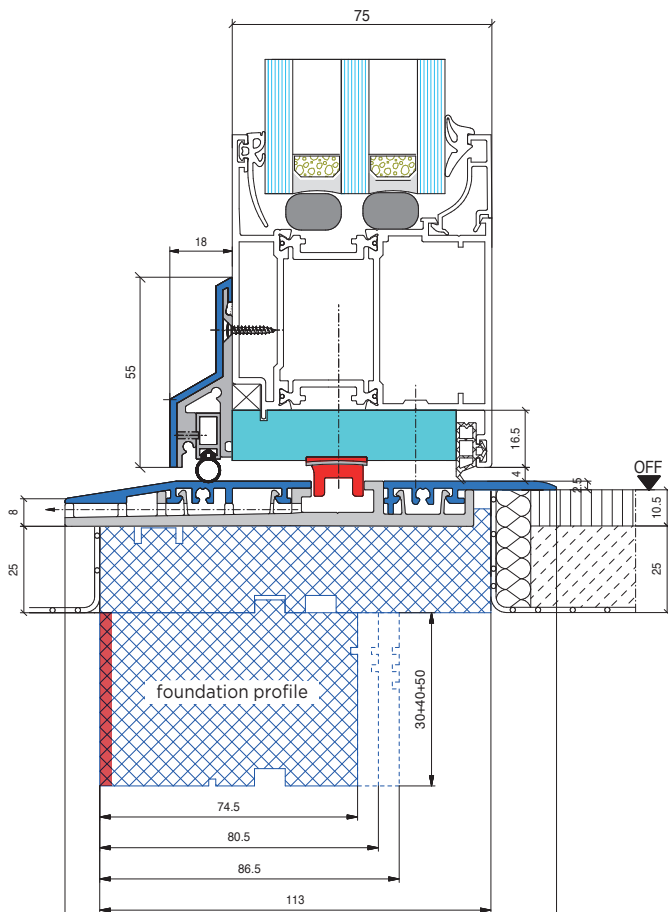

Comfort threshold for **plastic house doors**  
incl. threshold foundation 113 x 25 mm (PET)  
+ additional foundation profile (30, 40, 50 mm  
high) positioned flush **inside**.

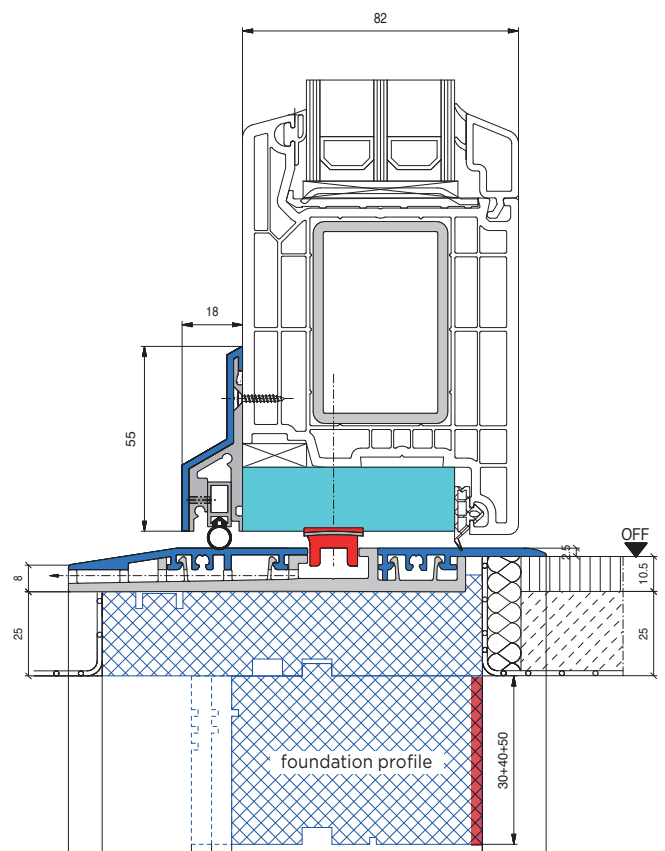

- 1 Aluminum weatherboard with profile cover surface in choice of EV 1 silver, anthracite RAL 7016, bronze C33, white RAL 9016 or plain.
- 2 Plastic magnet holder profile 7 x 43 mm (brown or white)
- 3 Upper magnet seal profiles with insulation and double adhesive tape (3 x 17 mm). An additional fixture is recommended for fastening permanently.
- 4 Adjustable silicone slide seal in the weatherboard, sealed and cleaned, with threaded pins 5 x 6 mm for invisible fastening
- 5 Aluminum floor profile EV1 anodized with PVC center section and drainage slots
- 6 Groove additional TPE seal (groove 5 x 13 mm) before painting, in order to restore the circumferential seal level (glue seal if necessary). Mount seal lip flush with the frame inner edge.
- 7 Two lower magnet seal profiles (9 x 15 mm), **always insert with the nose pointing to the outside.**

**NEW: WITH PVC CENTER SECTION.**

The magnet double seal is cut and delivered in fixed lengths to the decorative frame outer dimensions (up to max. 6,000 mm length).

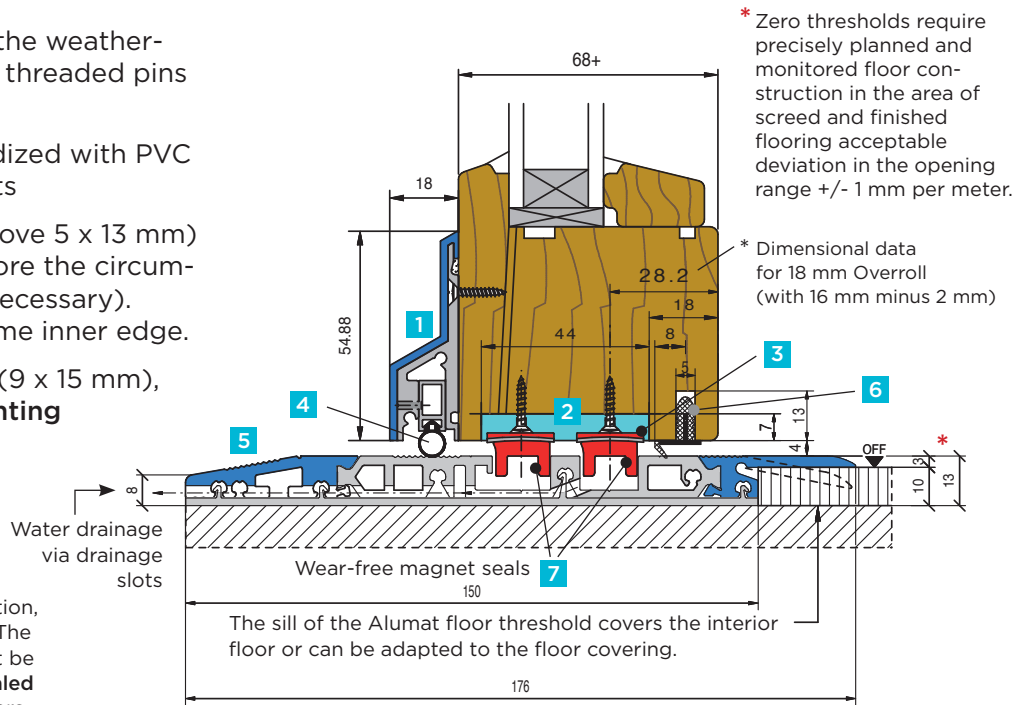

## MFZ 10/1

With integrated exterior doors in old construction, the existing stop threshold must be removed. The barrier-free ALUMAT magnet double seal must be fitted into the decorative frame rebate and **sealed on the side**. Either shorten or lengthen the doors with approx. 4 mm gap to the ALUMAT floor profile.

## MFZ 10/2

With lower lying patios or balconies the leveling to the ALUMAT floor profile can be done using elevated wood and plastic covering.

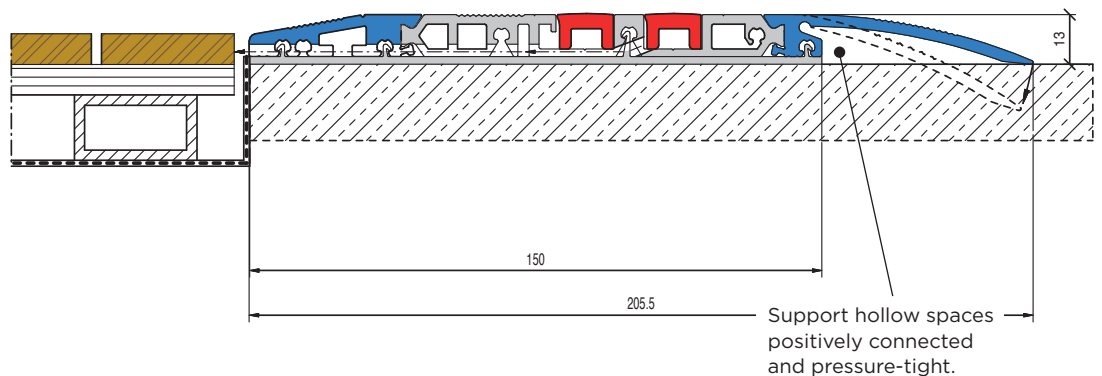

## MFZ 10/3

Level differences from higher lying patio covering of from 10 to 30 mm to the interior floor covering can be bridged with the adaptable inclined ramp.

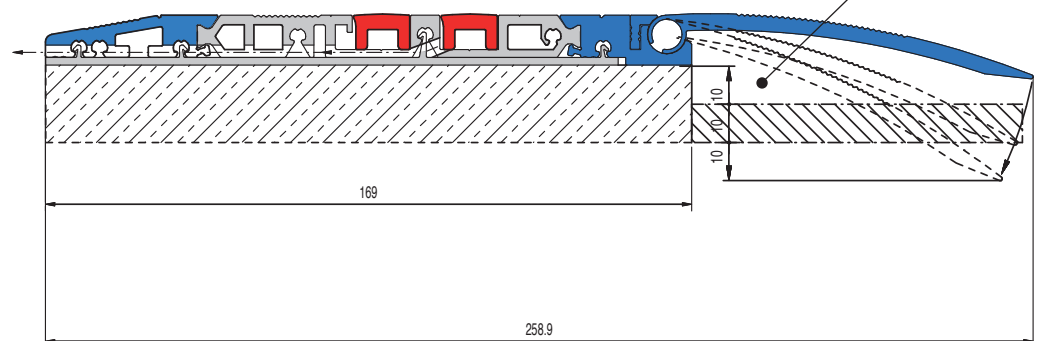

- 1** Aluminum weatherboard with profile cover, surface in choice of EV 1 silver, anthracite RAL 7016, bronze C33, white 9016 or plain.
- 2** Plastic magnet holder profile, white, factory-fitted to width and prefabricated to sash rebate dimension upon request. Interior magnet guide is identical to the hardware groove.
- 3** Upper magnet seal profiles with insulation and double adhesive tape (3 x 17 mm). Upon entering the FFM, the upper magnets are permanently mounted at the factory.
- 4** Adjustable silicone slide seal sealed in weather board and cleaned, 2 threaded pins 5 x 6 mm for invisible mounting. Seal base with permanent connection in the aluminum profile.
- 5** Aluminum floor profile EV1 anodized with PVC center piece for thermal separation with drainage slots.
- 6** Additional TPE seal, so that the circumferential sealing level is restored to the same as the doorstop (system dependent).

- 7** Two lower magnet seal profiles (9 x 15 mm), always insert with nose pointing to the outside.

The magnet double seal is cut and delivered in fixed lengths to the decorative frame outer dimensions (up to max. 6,000 mm length).

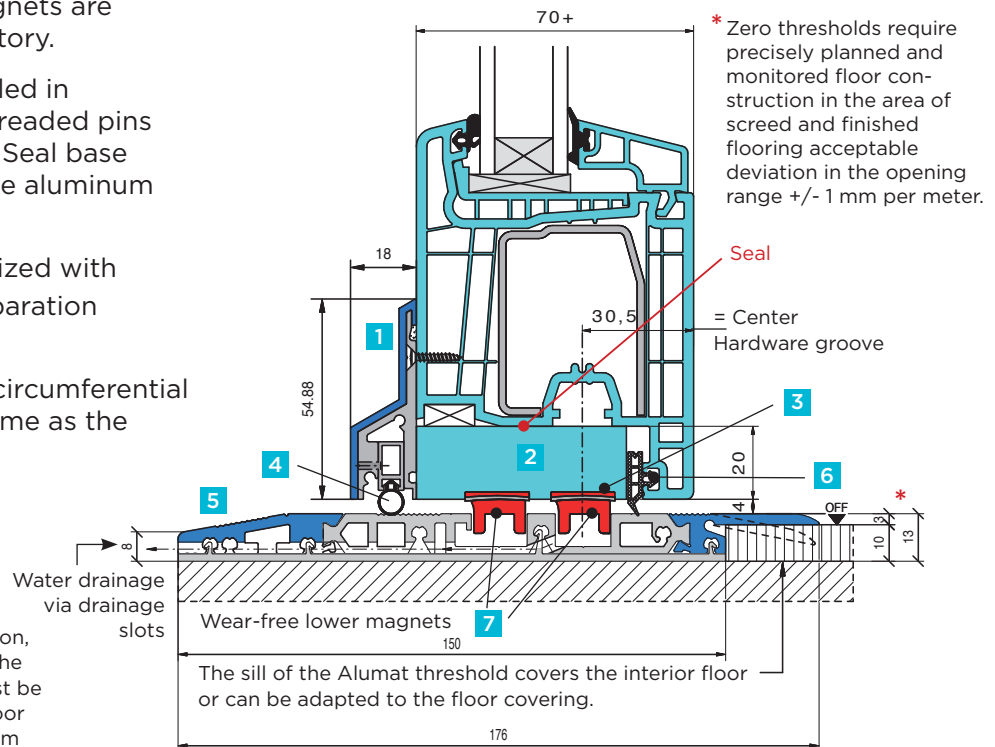

## MFZ 20/1

With integrated exterior doors in old construction, the existing stop threshold must be removed. The barrier-free ALUMAT magnetic double seal must be fitted in the decorative frame rebate and the door must be either extended or shortened with 4 mm clearance to the ALUMAT floor profile.

## MFZ 20/2

With lower lying patios or balconies the leveling to the ALUMAT floor profile can be done using elevated wood and plastic covering.

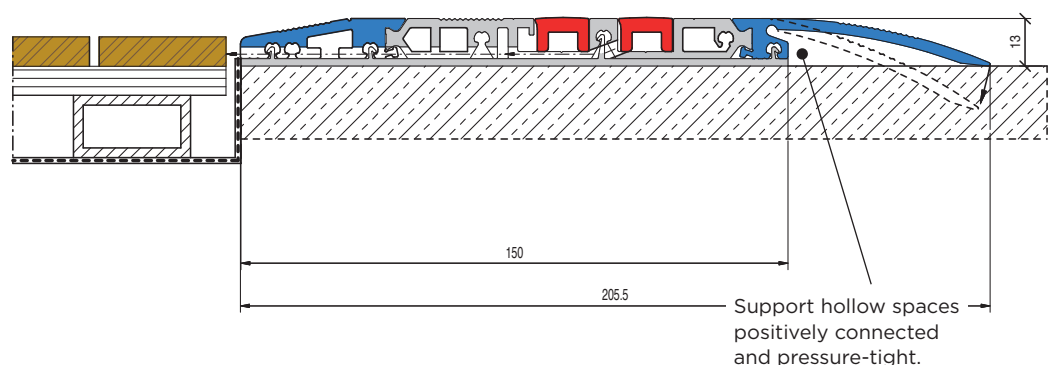

## MFZ 20/3

Level differences from higher lying patio covering of from 10 to 30 mm to the interior floor covering can be bridged with the adaptable inclined ramp.

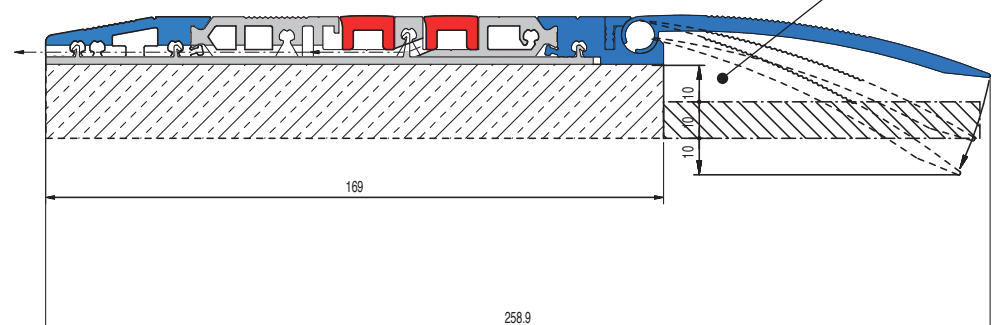



- 7 Additional TPE seal, so that the circumferential sealing level is restored to the same as the doorstop (system dependent).
- 6 Two lower magnet seal profiles (9 x 15 mm), always insert with nose pointing to the outside.

75

\* Zero thresholds require precisely planned and monitored floor construction in the area of screed and finished flooring acceptable deviation in the opening range  $\pm 1$  mm per meter.

Seal

= Center hardware groove

18

54.88

1

2

3

4

5

6

7

Water drainage via drainage slots

Wear-free lower magnets

150

The sill of the Alumat threshold covers the interior floor or can be adapted to the floor covering.

176

10

13

8

OFF \*

With integrated exterior doors in old construction, the existing stop threshold must be removed. The barrier-free ALUMAT magnetic double seal must be fitted in the decorative frame rebate and the door must be either extended or shortened with 4 mm clearance to the ALUMAT floor profile.

Support hollow spaces positively connected and pressure-tight.

150

205.5

12

Level differences from higher lying patio covering of from 10 to 30 mm to the interior floor covering can be bridged with the adaptable inclined ramp.

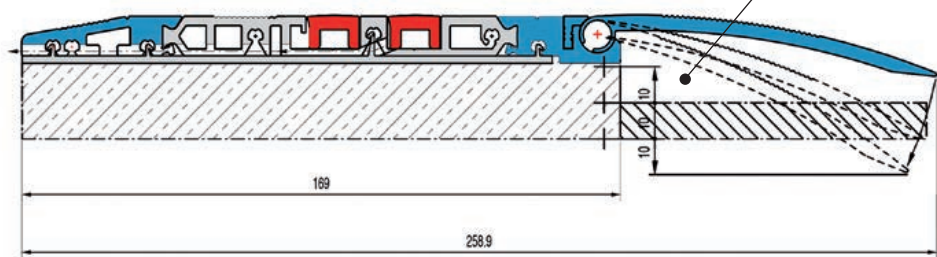

Auxiliary profiles for lower lying outer covering

## MFZ 10/1 or MFZ 20/1 with TYPE RA

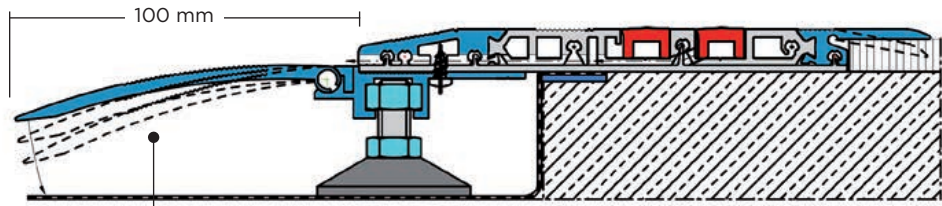

Support hollow spaces positively connected and pressure-tight!

For approx. 25-40 mm level difference to lower lying outer covering with set screws.

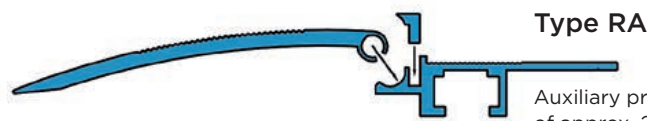

Auxiliary profile with level difference of approx. 25-40 mm

## MFZ 10/1 or MFZ 20/1 with aluminum bridging profile

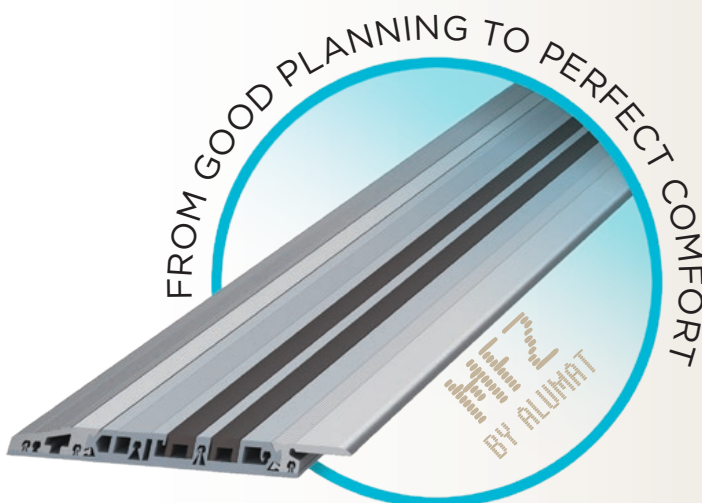
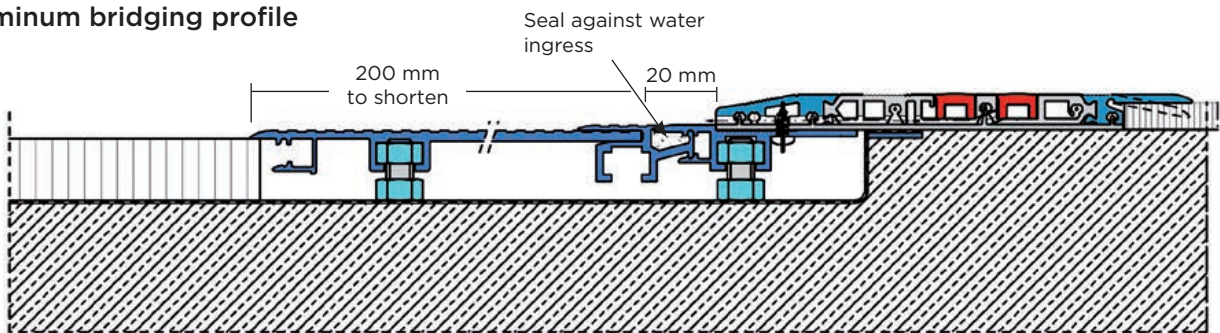

### FLEXIBLY ADAPTABLE

The special feature of this renovation profile is its extremely low installation height that can be easily set directly on every rough floor. The ALUMAT magnet double seal extraordinarily adapts itself to a wide variety of installation conditions.

Different floor heights can be leveled with various ALUMAT auxiliary profiles.

Lift-and-slide door flat threshold  
**without** floor recess, thermally separated.  
 Aluminum EV 1 anod. with PVC center section.

Calculation according to stock lengths:  
 2,500 / 3,000 / 3,500 / 4,000 / 4,500 / 5,000 / 5,500 /  
 6,000 / 6,500 mm (cut to length to fixed dimension)

**TYPE HST 10**  
 with straight aluminum sills

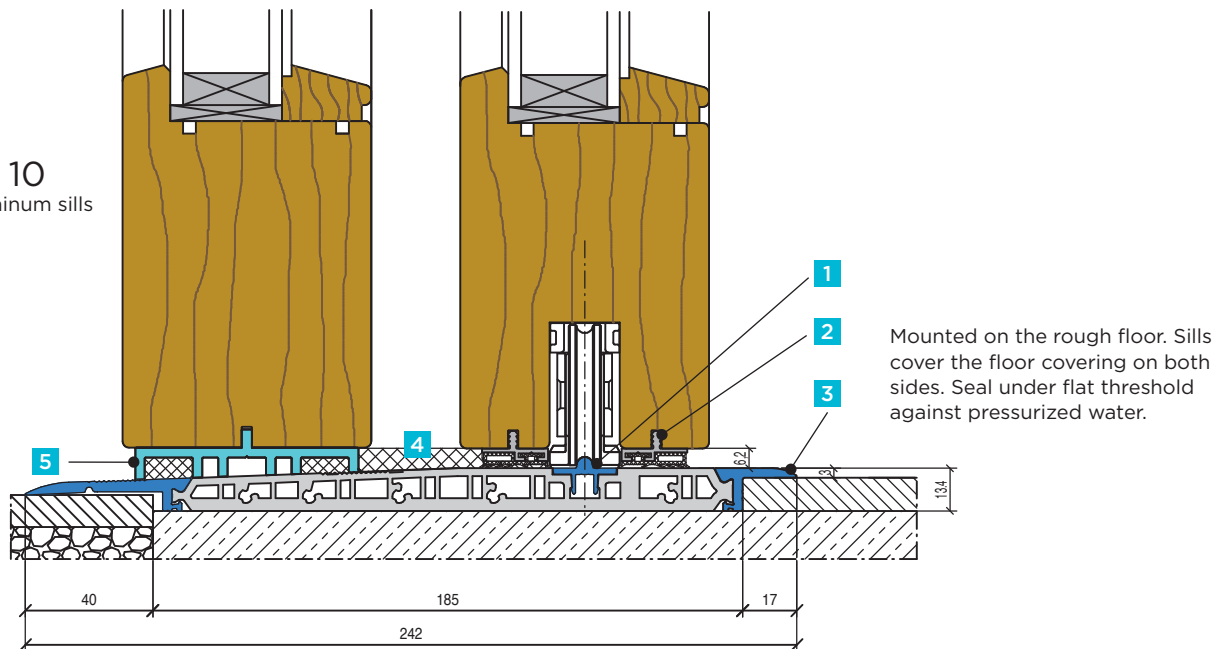

**TYPE HST 10/1** with bent aluminum sills

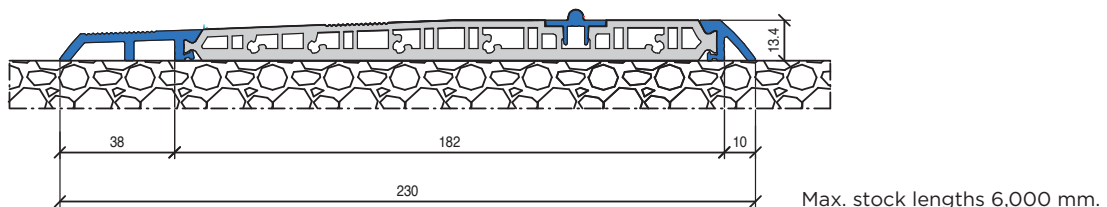

## In general included in the scope of delivery:

- 1 Aluminum roller guides EV 1 anodized to clip-on.
- 2 Aluminum seal holder with EPDM seal adhered slip-proof.
- 3 Aluminum flat threshold EV 1 anodized with PVC center section, thermally insulated with UV resistant film cover.
- 4 EPDM sealing cushion as a set.
- 5 Plastic adapter for fixed part, light gray; width 70 mm.
- 6 A pair of plastic threshold connectors including sealing (depending on the system).
- 7 One pair front covers for flat threshold.

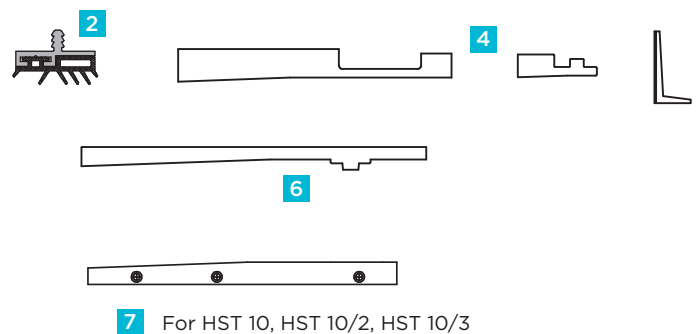

When installing on the continuous floor (tile, marble, etc.) the sills on both sides are already adapted to the floor covering. Seal under flat threshold against pressurized water.

## Note:

Due to various structural connection situations, condensation can occasionally form in the threshold area during extreme fluctuations in temperature. Driving rain seal should be requested depending on the system. Passive house compatibility is not certified. The PVC floor profile may cause UV-related discoloration.



Lift-and-slide door flat threshold  
**without** floor recess, thermally separated.  
 Aluminum EV 1 anod. with PVC center section.

Calculation according to stock lengths: 2,500 / 3,000 / 3,500 / 4,000 / 4,500 / 5,000 / 5,500 / 6,000 / 6,500 mm  
 (Cut to fixed dimensions with decorative frame adapter pre-drilled ready for installation on threshold)

### TYPE HST 20 with straight aluminum sills

Mounted on the rough floor. Sills cover the floor covering on both sides. Seal under flat threshold against pressurized water.

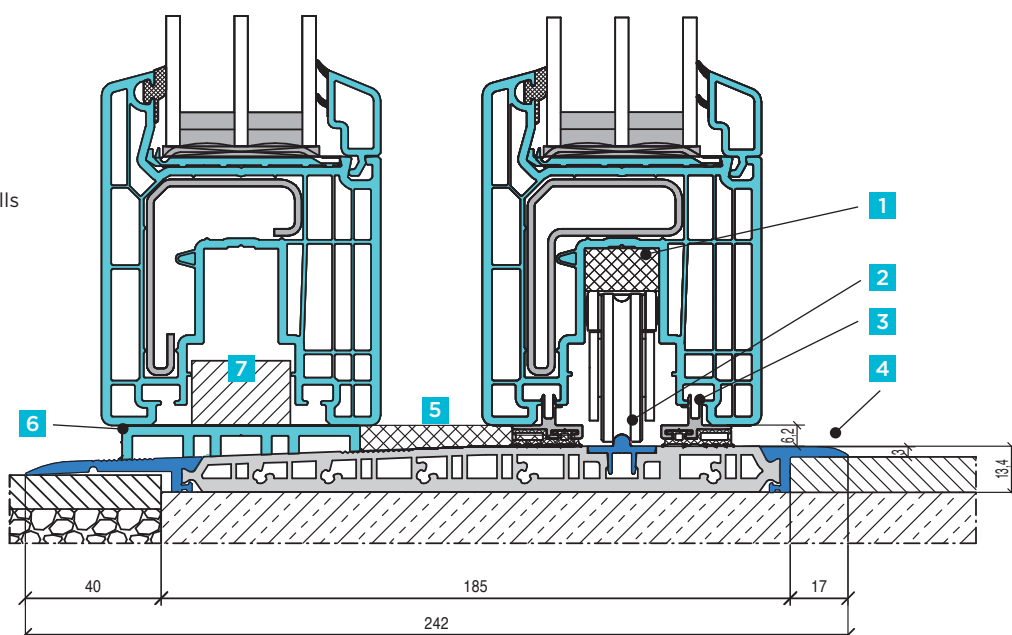

### TYPE HST 20/1 with bent aluminum sills

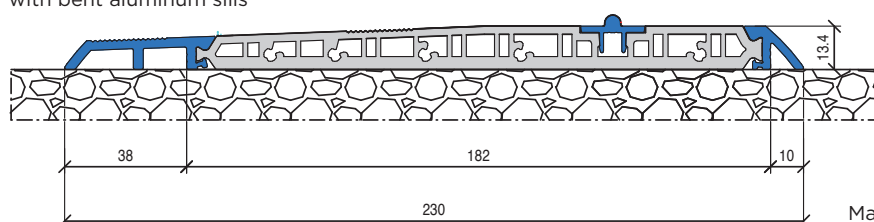

Max. stock lengths 6,000 mm.

#### In general included in the scope of delivery:

- 1 Plastic roller shimming, 1 piece 230 mm / 1 piece 120 mm (system-dependent adapted)
- 2 Aluminum roller guides EV 1 anodized to clip-on
- 3 Aluminum seal holder system-specific with EPDM seal adhered slip-proof.
- 4 Aluminum flat threshold EV 1 anodized with PVC center section, thermally insulated with UV resistant film cover
- 5 EPDM sealing cushion as a set
- 6 Plastic adapter for fixed part, light gray; width 70 mm.
- 7 Filler piece system-specific
- 8 One pair threshold connectors incl. seal (system dependent). Factory made holes on threshold (ready for installation).
- 9 One pair front covers for flat threshold

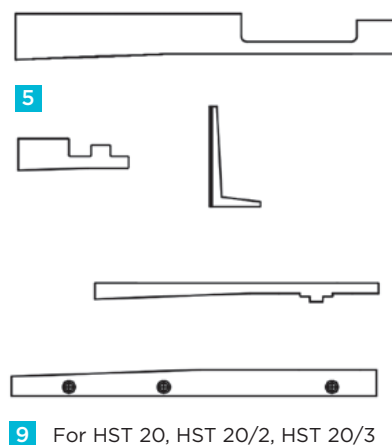

9 For HST 20, HST 20/2, HST 20/3

When installing on the continuous floor (tile, marble, etc.) the sills on both sides are already adapted to the floor covering. Seal under flat threshold against pressurized water.

#### Note:

Due to various structural connection situations, condensation can occasionally form in the threshold area during extreme fluctuations in temperature. Driving rain seal should be requested depending on the system. Passive house compatibility is not certified. The PVC floor profile may cause UV-related discoloration.

## HST 10/2 + 10/3

Lift-and-slide door flat threshold

**with** floor recess, thermally separated.

Aluminum EV 1 anod. with PVC center section.

Calculation according to stock lengths:

2,500 / 3,000 / 3,500 / 4,000 / 4,500 / 5,000 / 5,500 /  
6,000 / 6,500 mm (cut to length to fixed dimension)

### TYPE HST 10/2

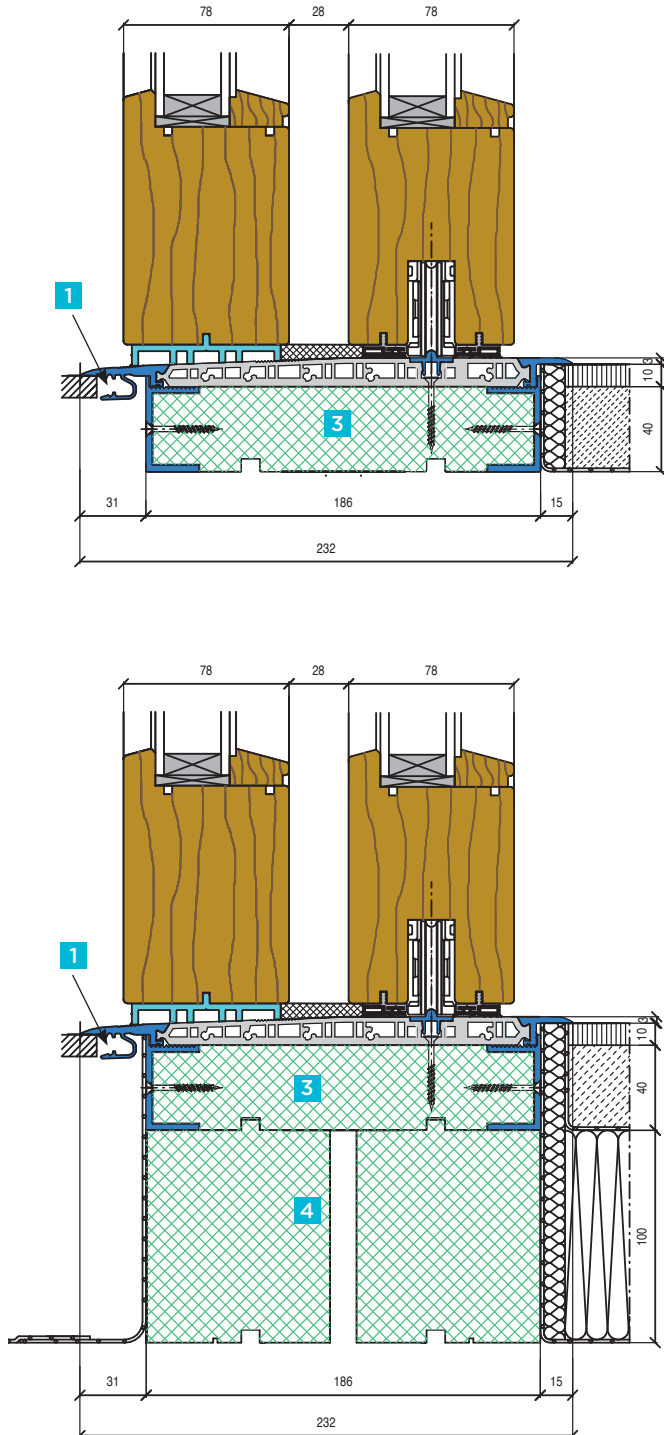

### TYPE HST 10/3

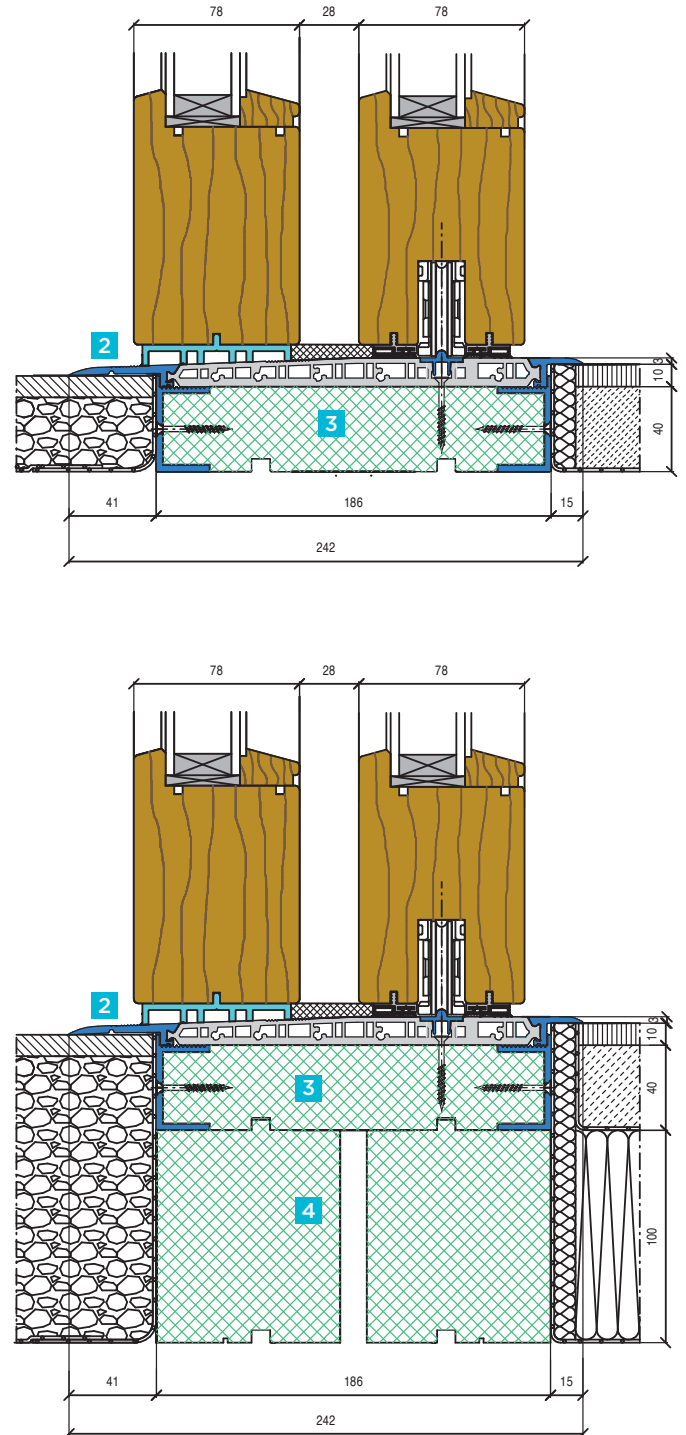

**1** Standard design **with** exterior clipping function for auxiliary profiles

**2** Design with straight sills **without** exterior clipping function for auxiliary profiles

**3** HST base profile for threshold foundation 182 x 40 mm (Material: PET).

**4** Available for additional charge:  
Two-piece load-bearing thermal insulation for sticking on the HST base profile (Plug connection of 30, 40 and 50 mm).

**HST 20/2 + 20/3**

Lift-and-slide door flat threshold

**with** floor recess, thermally separated.

Aluminum EV 1 anod. with PVC center section.

Calculation according to stock lengths: 2,500 / 3,000 / 3,500 / 4,000 / 4,500 / 5,000 / 5,500 / 6,000 / 6,500 mm

(Cut to length to fixed dimension with decorative frames, pre-drilled and ready for assembly on threshold)

TYPE HST 20/2

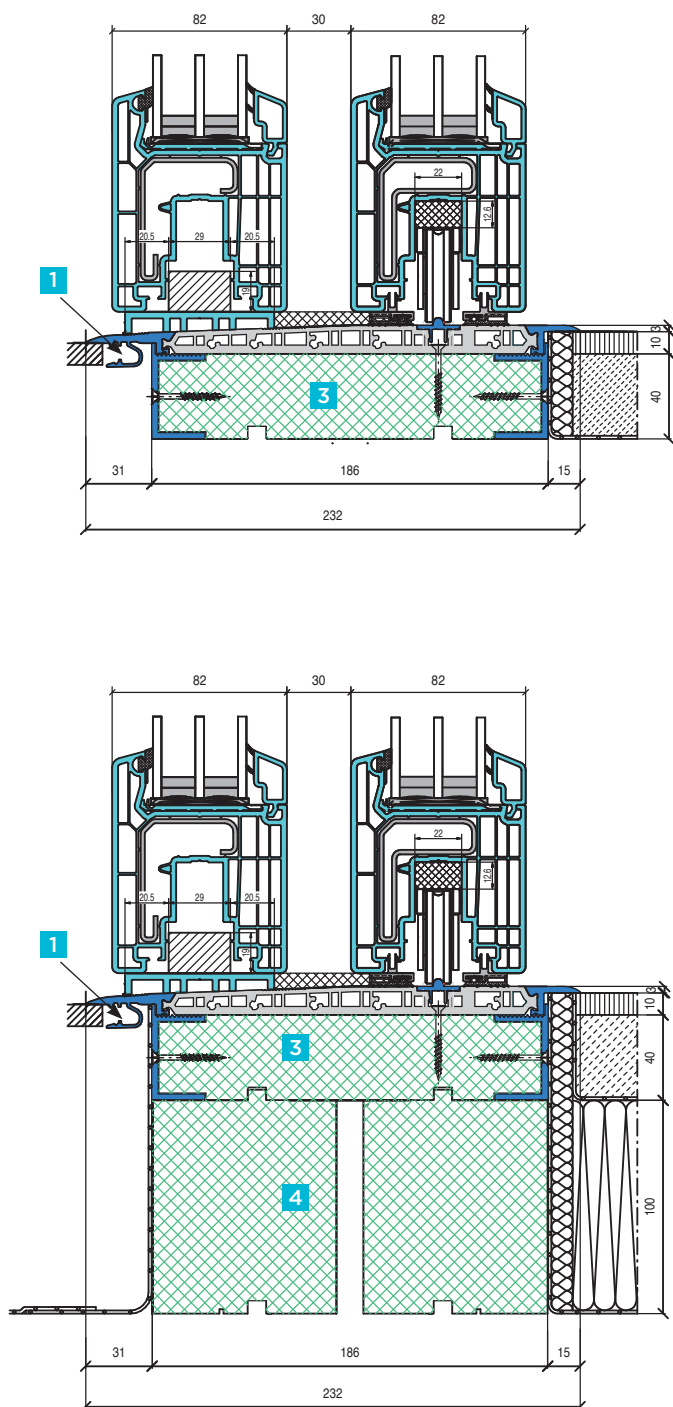

TYPE HST 20/3

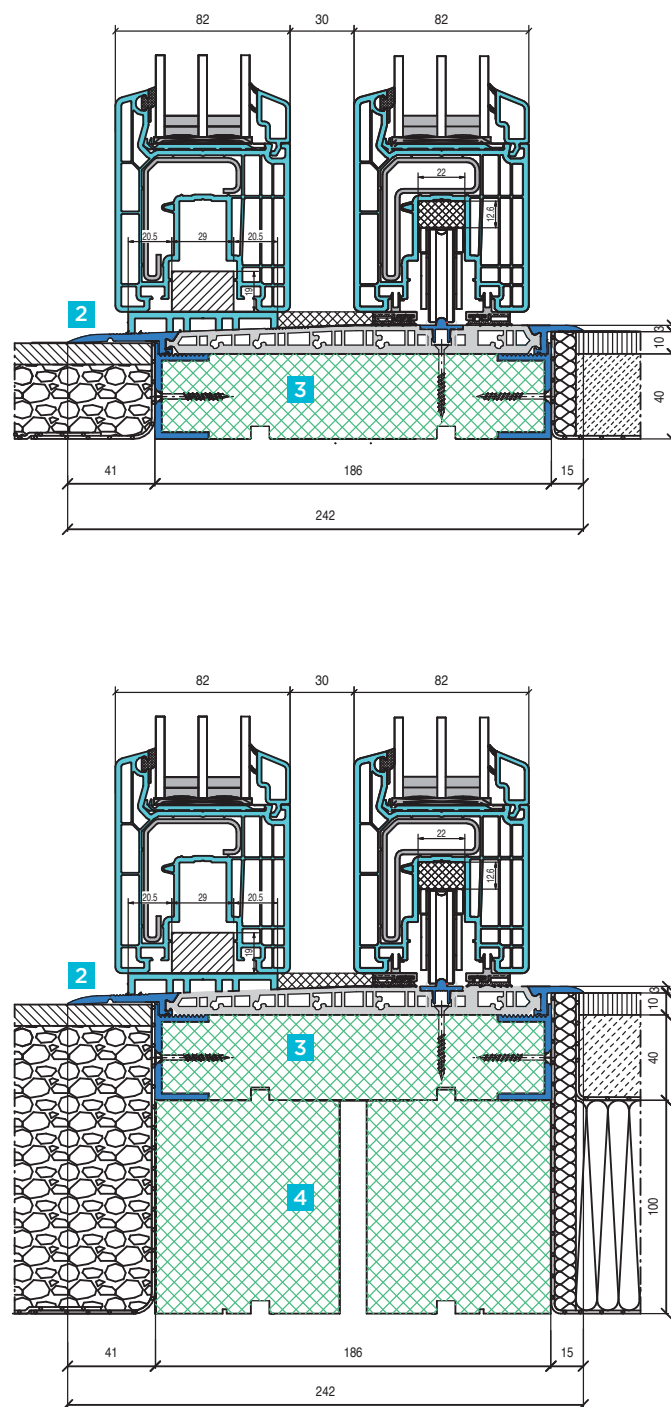

**1** Standard design **with** exterior clipping function for auxiliary profiles

**2** Design with straight sills **without** exterior clipping function for auxiliary profiles

**3** HST base profile for threshold foundation 182 x 40 mm (Material: PET).

**4** Available for additional charge:  
Load-absorbing thermal insulation, two-part for sticking on the HST base profile (Plug connection of 30, 40 and 50 mm).



Can be clipped-on on the exterior of flat threshold for fixed connection

## ALUMINUM BRIDGING PROFILE

incl. adjustable feet  
Variable depth 85 to 250 mm.

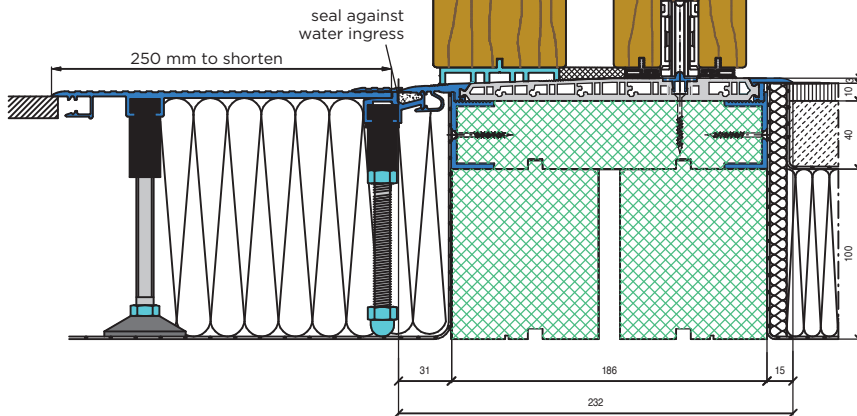

## CALCULATION OF THE ENTIRE FLOOR STRUCTURE:

- HST flat threshold 10 mm floor recess
- + base profile 40 mm
- + variable thermal insulation for threshold foundation

## ALUMINUM CHANNEL FRAMES

incl. system grates; available in installation depth 120 or 170 mm.

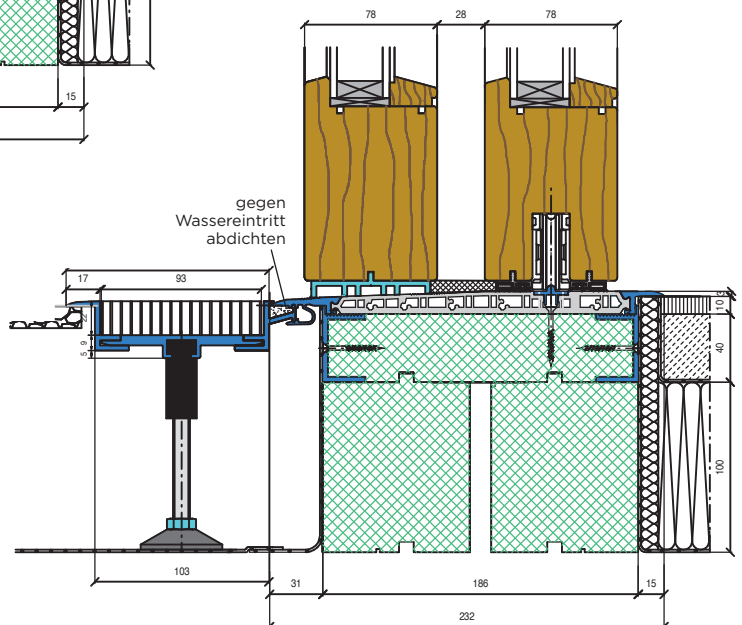

## DOORMAT BLACK RUBBER

incl. clip-on aluminum frame and adjustable feet. Standard 600 x 400 mm. Custom lengths in increments of 600 mm available on request.

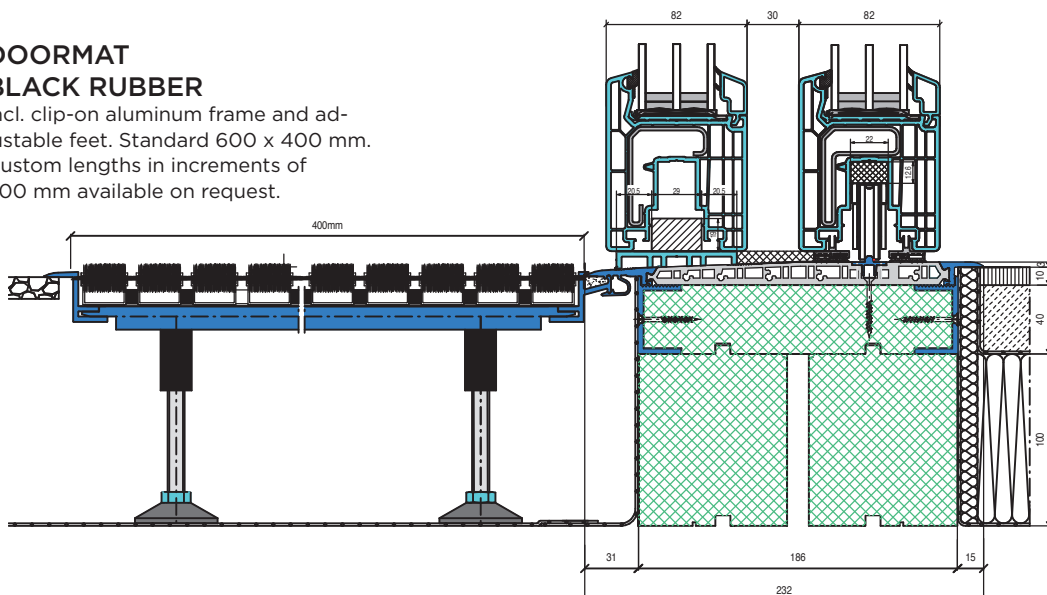

# Magnet door seals for interior doors

Material:	Aluminum
Dimensions:	B 135 x H 11.5 mm
Lengths:	up to 6,000 mm (every fixed length possible)
Seal:	Permanent magnets Lower magnet 15 x 9 mm Upper magnet 17 x 3 mm
Height compensation:	up to 35 mm through variable hinge threshold
Installation:	in frame fold with two-sided notch

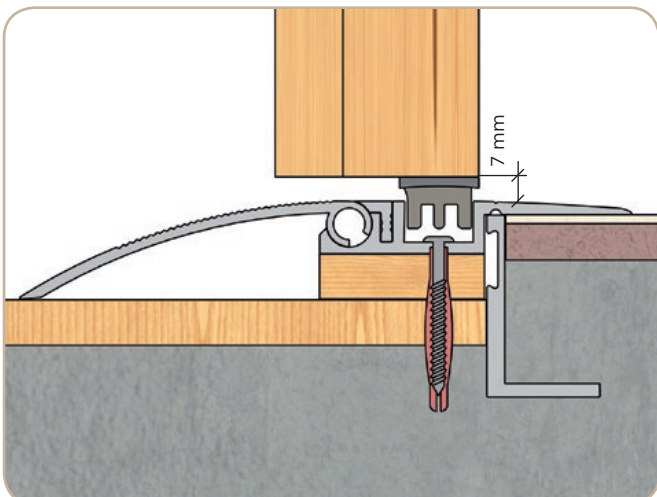
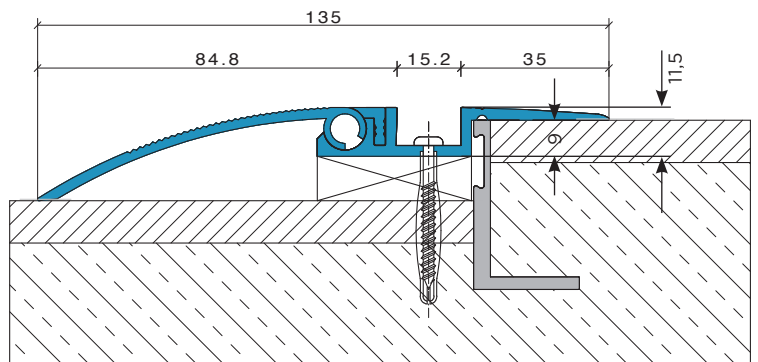
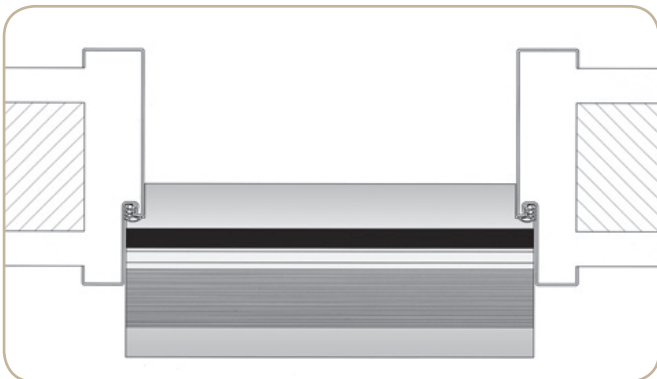

Obstacle free thanks to renovation profile MGS

## Universal profiles

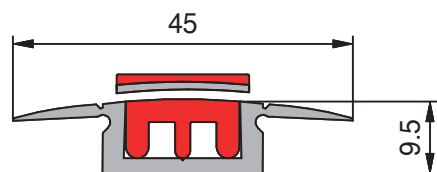

Type MTK 2

Aluminum profile available in surface design:

- anodized silver
- gold
- bronze

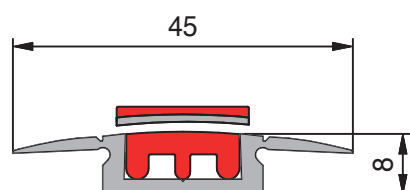

Type MTK 3

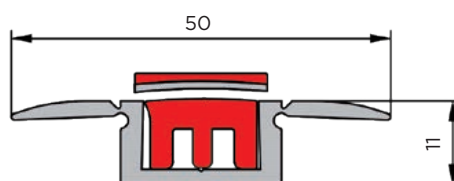

Type MTK 6

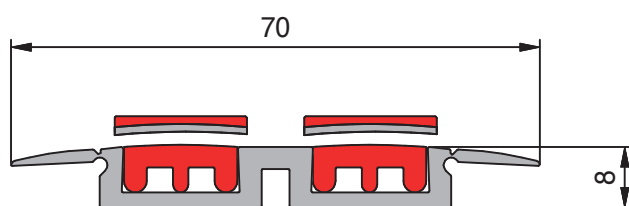

Type MTK 32

Aluminum profile available in surface design:

- anodized silver
- bronze

## Standard profiles

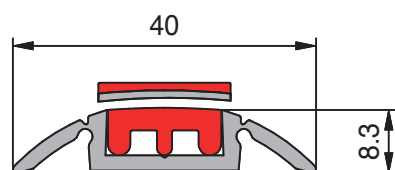

Type MA 1

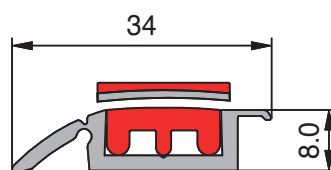

Type MA 2

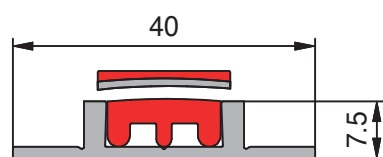

Type MF 1

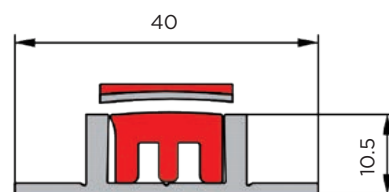

Type MF 2

Aluminum profile available in surface design:

- anodized silver
- bronze

Every fixed length up to 6,000 mm

## Special profiles

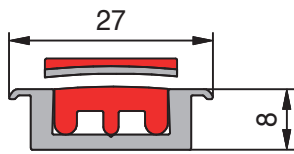

Type MFS 1

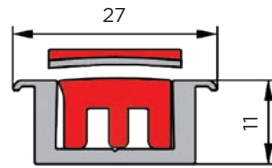

Type MFS 10

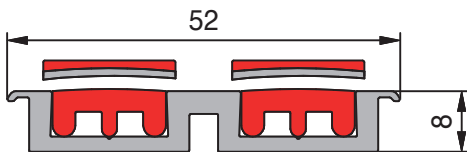

Type MFS 2

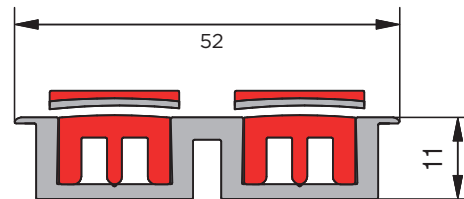

Type MFS 20  
(only in anodized silver)

Aluminum profile available  
in surface design:  
■ anodized silver  
■ bronze

## Special auxiliary profiles for glass doors

Aluminum profile available  
in surface design:  
■ anodized silver

The self-adhesive upper magnet strip is not included in the scope of delivery of GT 8 or GT 10, since these are delivered with the respective aluminum floor profile.

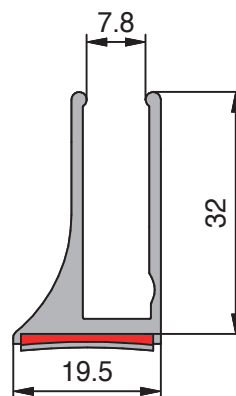

Type GT 8

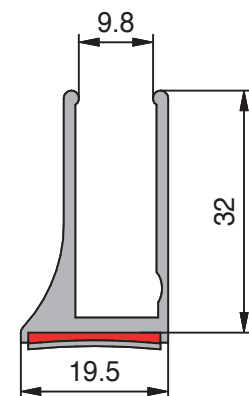

Type GT 10

## Only in combination with magnet floor profile

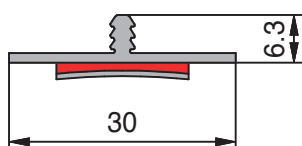

Type OMT

Aluminum profile available  
in surface design:  
☐ plain

The self-adhesive upper magnet strip is not included in the scope of delivery of type OMT, since these are delivered with the respective aluminum floor profile.

Fixed length up to 6,000 mm



## For wood and steel frames

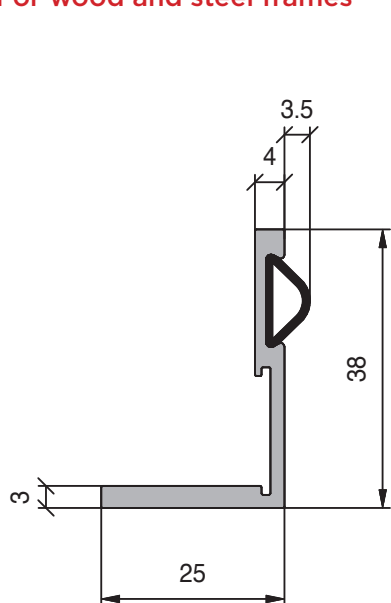

Type ST I  
for steel frames

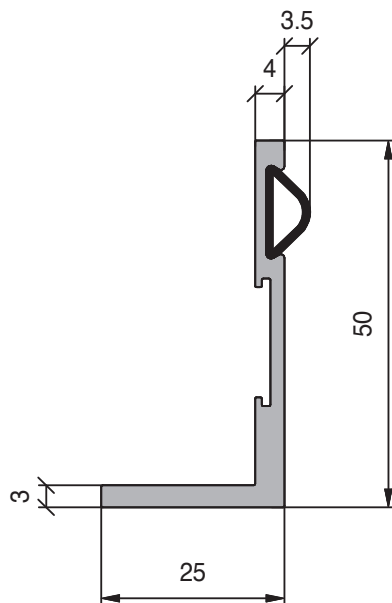

Type ST I  
for steel frames

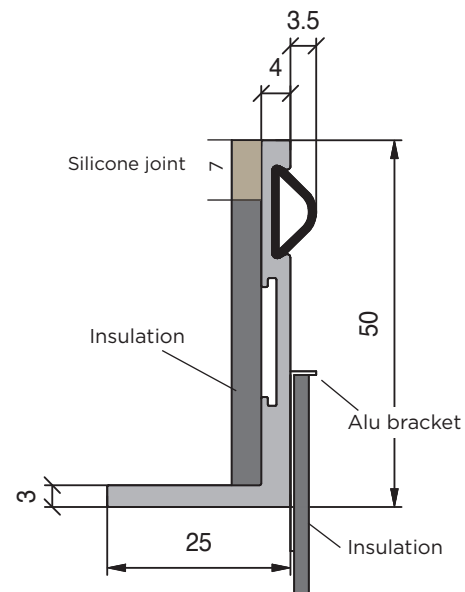

Type ST I / WAT I  
for steel frames

### Notch type ST I for steel frames

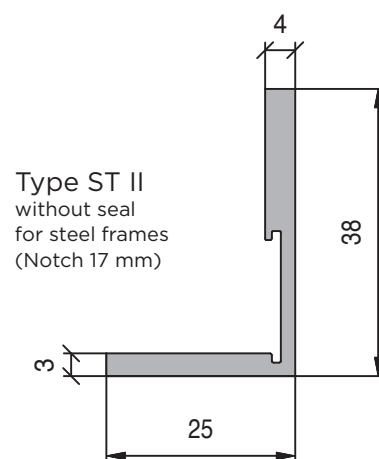
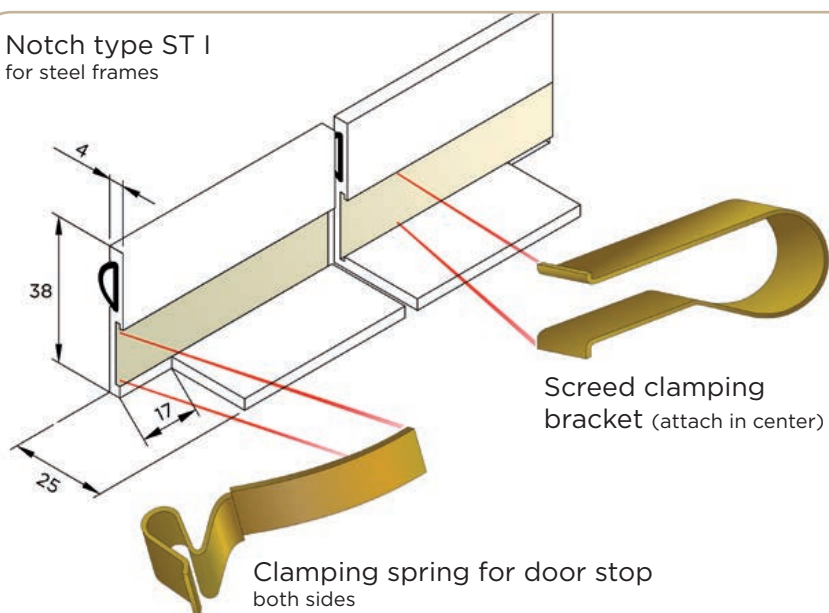

Type ST II  
without seal  
for steel frames  
(Notch 17 mm)

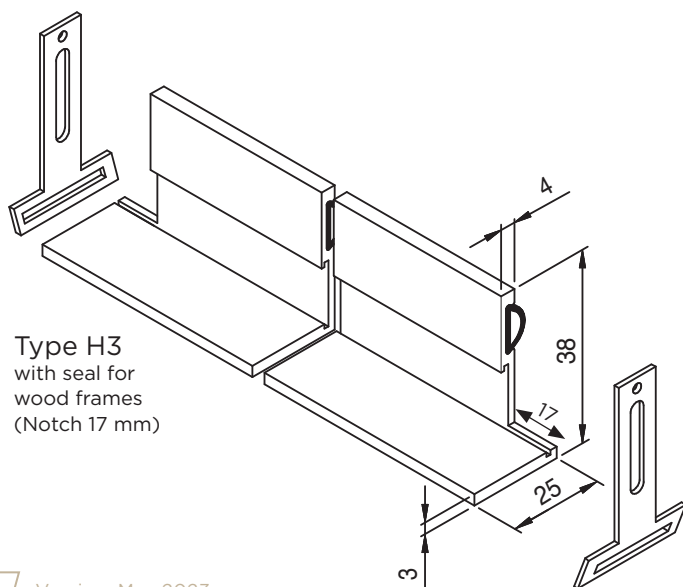

Type H3  
with seal for  
wood frames  
(Notch 17 mm)

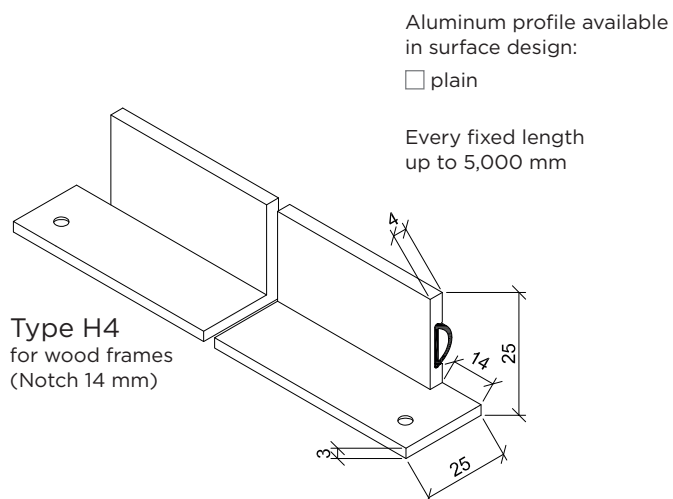

Type H4  
for wood frames  
(Notch 14 mm)

Aluminum profile available  
in surface design:

☐ plain

Every fixed length  
up to 5,000 mm

Wooden house door threshold rails  
with black EPDM seal

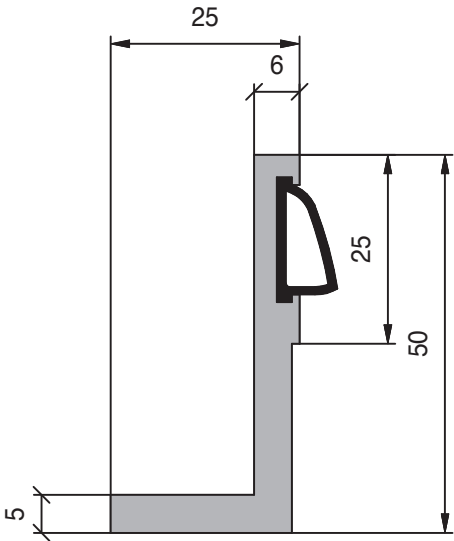

Type HT 1

Aluminum profile available  
in surface design:  
☐ plain

Every fixed length  
up to 6,000 mm

Aluminum seal carrier  
with grey silicone seal

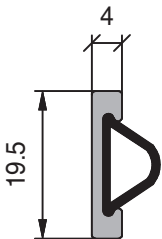

Type H/ST

Every fixed length up to 6,000 mm

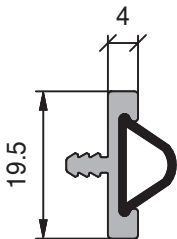

Type ZH/ST

Every fixed length up to 5,500 mm

Aluminum profile available  
in surface design:  
☐ plain

Combination sealing rails  
with black EPDM seal

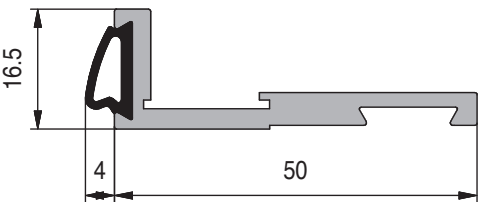

Type KS

Every fixed length up to  
6,000 mm

Aluminum profile available  
in surface design:  
☐ plain

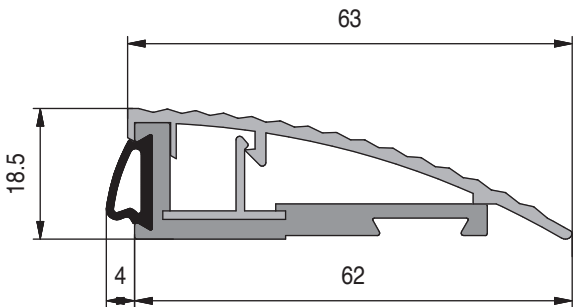

Type AKS

Every fixed length up to  
6,000 mm

Aluminum profile available  
in surface design:  
☒ anodized silver

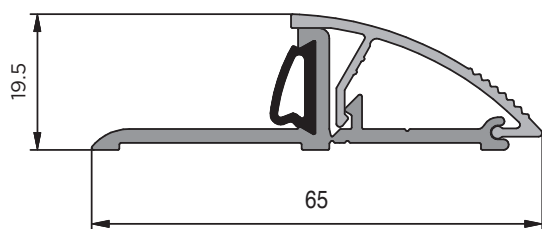

Type AKL

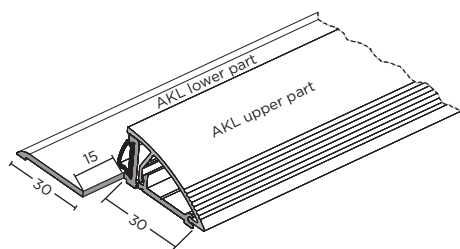

AKL notch for single fold

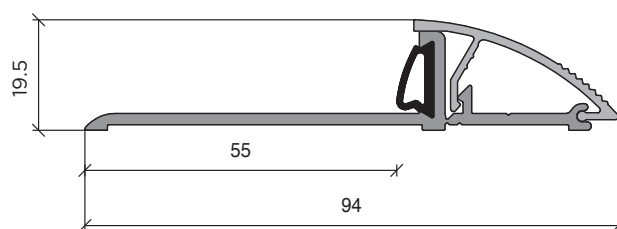

Type AKL plus

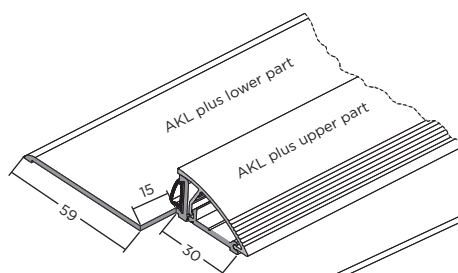

AKL plus notch for single fold

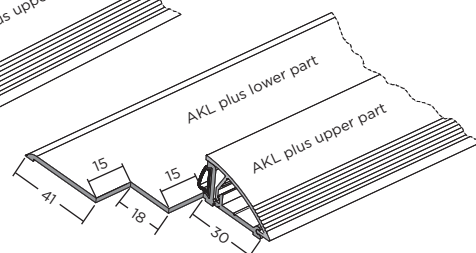

AKL plus notch for double fold

Notch only for standard steel frames for extra cost possible.

Aluminum profile available in surface design:

- anodized silver
- bronze

Every fixed length up to 5,000 mm

Aluminum profile available in surface design:

- anodized silver

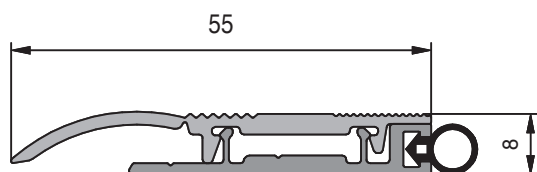

Type BM 30

Every fixed length up to 6,000 mm

Aluminum profile available in surface design:

- anodized silver
- gold
- bronze

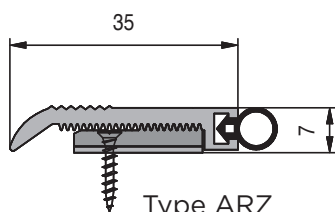

Type ARZ

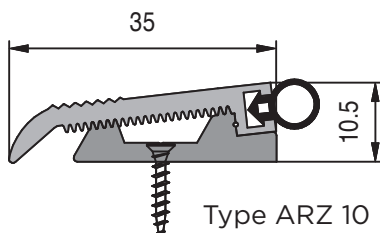

Type ARZ 10

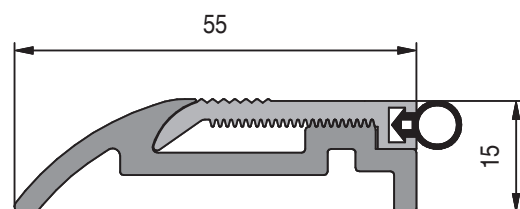

Type ARZ PLUS

Aluminum profile available in surface design:

- anodized silver

With grey silicone seal

Every fixed length up to 6,000 mm

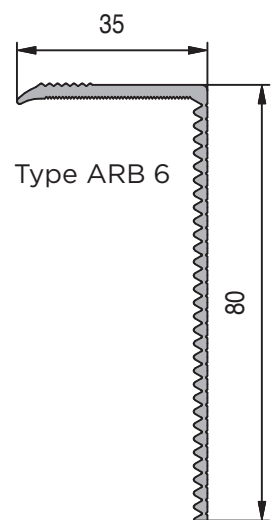
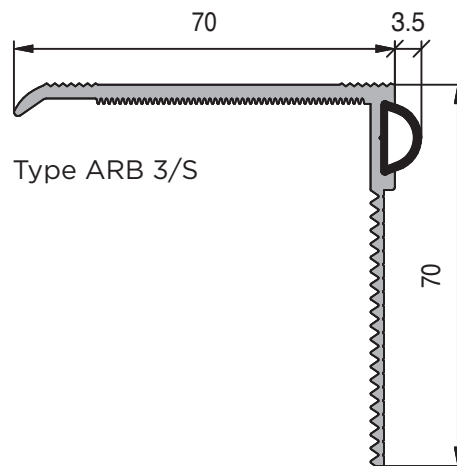
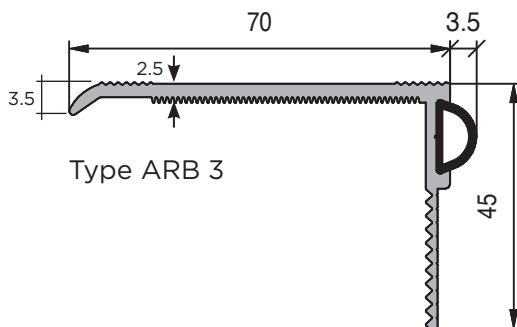
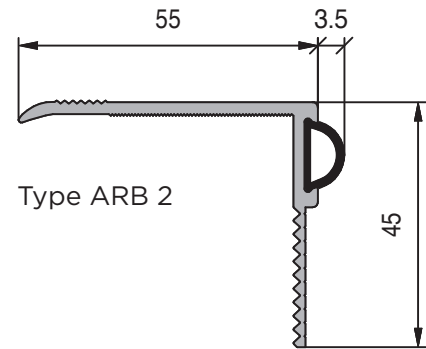
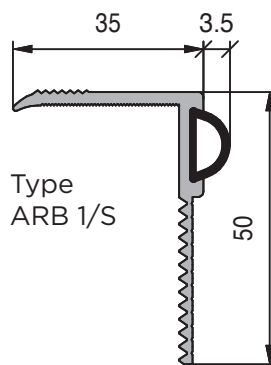
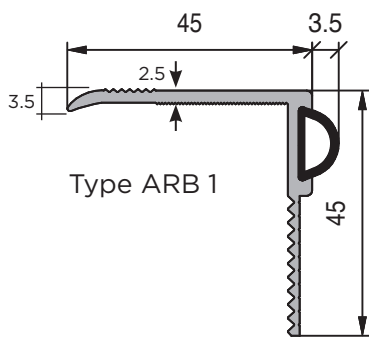

Aluminum profile available  
in surface design:

■ anodized silver

With grey silicone seal  
Every fixed length up to 6,000 mm

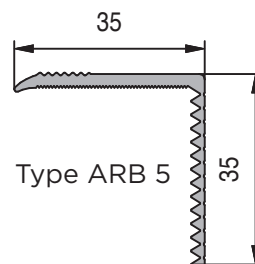

Aluminum profile available  
in surface design:

■ anodized silver  
■ gold  
■ bronze

## FLOOR FLAT THRESHOLD TYPE S I

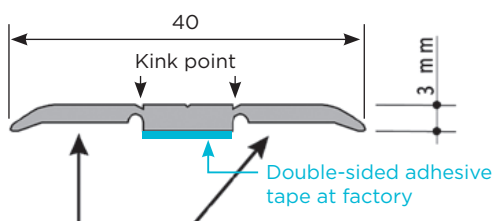

Constructional adhesive possibly in  
combination with hot-melt adhesive  
(use anchors with carpet)

Aluminum profile available  
in surface design:

■ anodized silver  
■ gold  
■ bronze

Every fixed length  
up to 6,000 mm



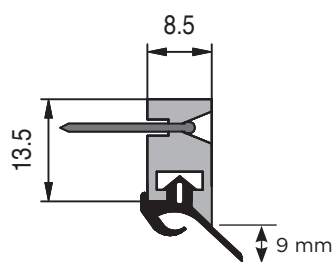

## Type ASD

Window seal made of plastic with silicone lip seal

Length 2,100 mm

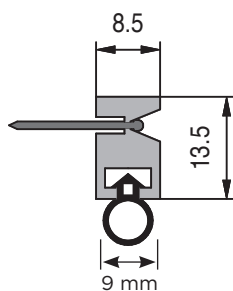

## Type ASD

Window seal made of plastic with silicone hose seal

Length 2,100 mm

Profile available in surface design:

□ white

■ dark brown

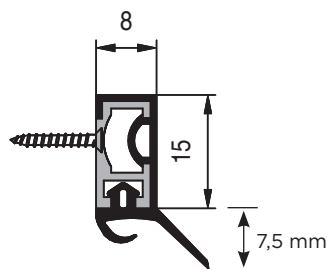

## Type SWD

Window seal (aluminum with silicone sheathing and lip seal)

Length 2,100 mm

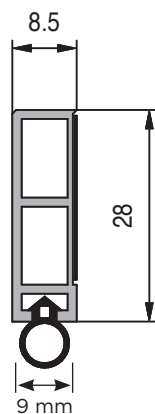

## Type ARD

Circumferential door seal made of plastic with silicone hose seal

Length 2,100 mm

Profile available in surface design:

□ white

■ beige

■ dark brown

SYSTEM-DEPENDENT TPE SEALS FOR SASH OVERLAP:  
TYPE MFAT PH AND MFZ

Rehau  
Brüggmann  
Salamander

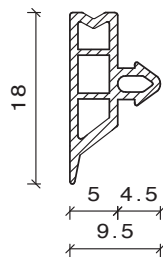

Gealan

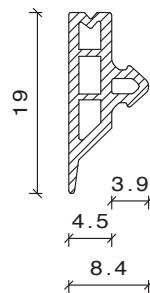

Schüco  
(PVC)  
Drutex

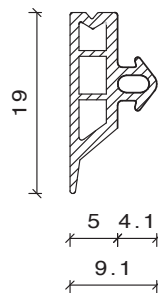

Profine  
Kömmerling  
Trocal  
KBE

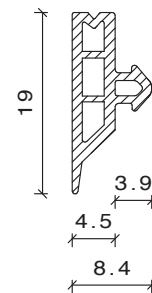

VEKA  
Aluplast

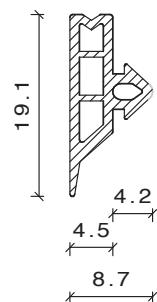

Inoutic  
Gutmann  
Heroal  
Akotherm

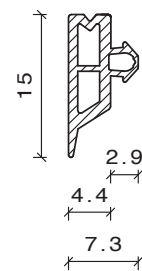

TKI  
Hueck  
Aluprof  
Pural

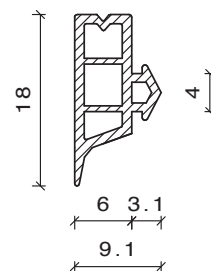

Schüco Alu  
Raico  
Alcoa  
Reynaers

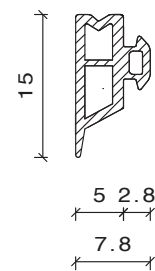

Wicona

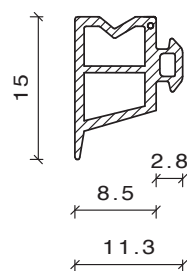

Other profiles

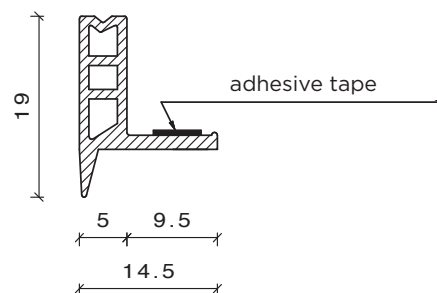

For wooden doors

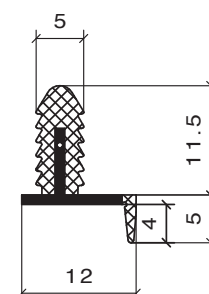



## About us

### Company history

The future oriented inventions of company founder Harry Frey have an authentic development background. He had a leg injury as a result of tripping over a threshold and falling. This negative experience inspired him to find a solution for the threshold problem. In 1980 Frey and his wife founded the company, that specializing in window and door seals. By 1988 the first magnet door seal for threshold-free transitions for interior doors had already been put on the market. After this success Harry Frey ventured into the development of a safe sealing solution for threshold-free transitions for exterior doors, an area of construction that is complex and legally difficult. He achieved success in this challenge after only nine years with his magnet double seal, where a total of two magnet profiles and two other seals ensure absolute security from water, air and noise. Since 1989, ALUMAT-Frey GmbH can look back with this innovative product on positive experience reports

and broadly diversified areas of application in totally different buildings, regardless of new construction or renovations. Frey holds the patent as inventor of the magnet double seal and thus is the only supplier of this prefabricated threshold-free door seal.

### The current trend – comfort for everyone and prevention from falls

With its sophisticated product development, ingenious technology and demanding design, he succeeded in simplifying going through a door for the lives of everyone with completely different abilities using four-fold protection buildings from water, wind and cold. For a significant target group, comfortable accessibility of interior and exterior rooms is only now at all possible with the magnet double seal. For the 18.1 million over-65 'Silver Age' persons living in Germany and the 7.9 million persons with severe disabilities, the same level door seal is a decisive health protection.

DD\_05.2023



Order forms for all ALUMAT zero thresholds can be found in the most current version at:

[www.alumat.de/online-bestell-anfrageservice](http://www.alumat.de/online-bestell-anfrageservice)



For latest news check out our profile on Facebook:

[www.facebook.com/Nullschwellen](https://www.facebook.com/Nullschwellen)