

MFZ 10 Renovation profile

- For wooden or wooden/aluminum exterior doors (house entrance, balcony, patio)
- Barrier-free magnet double seal acc. to Universal Design
- With PVC center section as optimum thermal isolation

MFZ 10

Ready-to-install delivery: Compatible with turn or tilt/turn doors, one- and two-leaf, forend/fixed glazing

Leveling from zero to 30 mm

No wear, no mechanics, 20 year warranty on magnet tension force

Rated joint sound reduction index $R_{S,w}$ up to 46 dB

For nursing homes, retirement homes, hospitals, homes for people with disabilities, day care facilities, kindergartens, own homes, Housing construction and hotels

Version Dec. 2024 · subject to technical changes



NEW: WITH PVC LOWER SECTION.

The magnetic double seal is supplied in fixed lengths to frame external dimensions (up to max. 6,000 mm length).

- 1** Aluminum weatherboard with profile cover surface in either EV1 silver, anthracite RAL 7016, bronze C33, white RAL 9016 or in plain available.
- 2** Plastic magnet holder profile 7 x 43 mm (light grey)
- 3** Additional fixation is recommended for permanent attachment.
- 4** Adjustable silicone seal with aluminium carrier profile seals and cleans, incl. threaded pins 5 x 6 for invisible fastening.
- 5** Aluminium floor profile EV1 anodised with pvc lower section and drainage slots.
- 6** Groove additional Tpe seal before painting (groove 5 x 13 mm). To restore the circumferential sealing level (glue seal if necessary) the sealing lip should be placed in the same plane as the existing stop seal.
- 7** Insert two bottom magnets (9 x 15 mm) with the **nose always pointing outwards**. Standard 2-footed up to 43 dB, alternatively 3-footed up to 46 dB sound insulator.

MFZ 10/1

For external doors installed in old buildings the existing threshold must be removed. The barrier-free ALUMAT magnet double seal must be fitted into the frame rebate and **sealed at the side**. Either extend or shorten the door with a gap of approx. 4 mm to the Alumat-floor profile.

* Zero thresholds require precisely planned and monitored floor construction in the area of screed and finished floor covering area (permissible deviation in the opening area +/- 1 mm per meter)

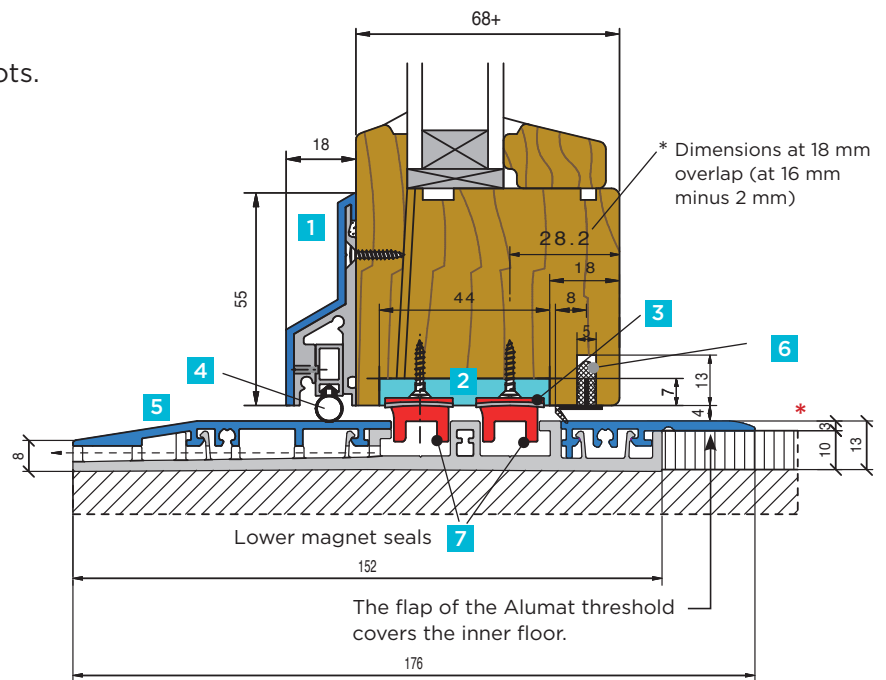

MFZ 10/2

For lower terraces or balconies the level can be equalised with the Alumat floor profile using raised wooden or plastic decking.

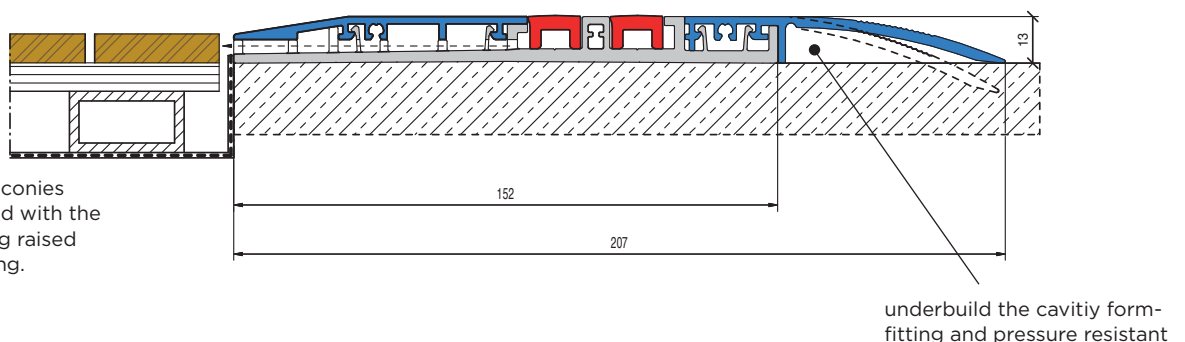

MFZ 10/3

Level differences of 10 to 30 mm from the higher outer floor covering to the inner floor covering can be bridged with the adjustable inclined run-up.

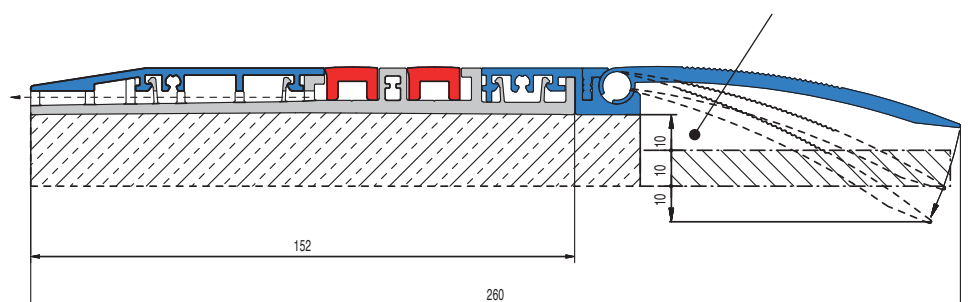

MFZ 10/1 incl. Basic profile 147 x 25 mm (PET)

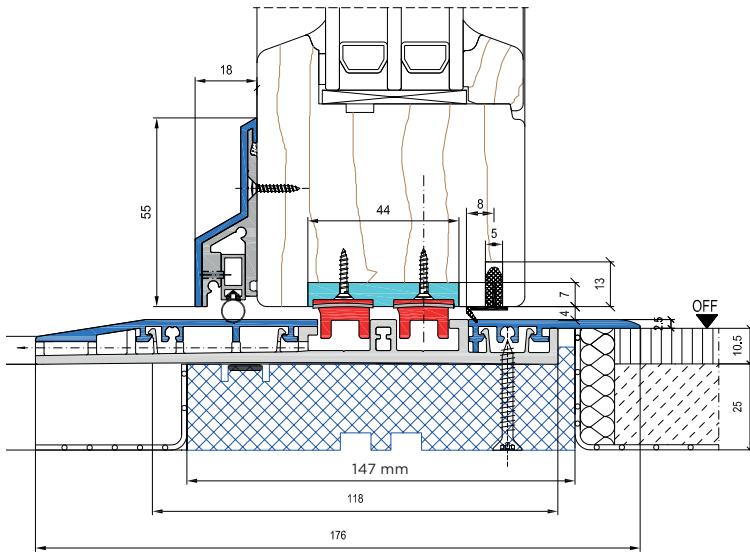

... with substructure positioned flush **inside or outside** (available in 3 different widths and heights)

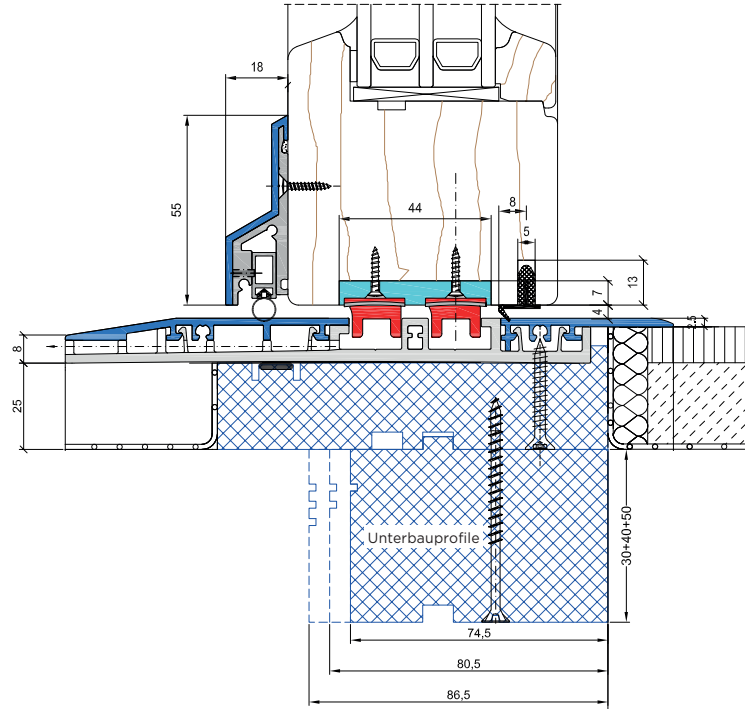

Auxiliary profiles to the lower-lying external covering

MFZ 10/1
with TYPE RA

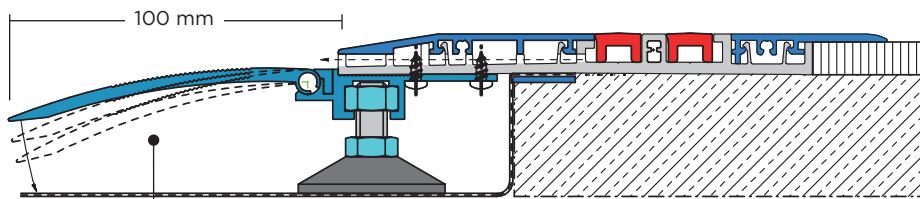

Underbuild the cavity form-fitting and pressure resistant

For approx. 25-40 mm level difference to the lower lying outer covering with adjusting screws

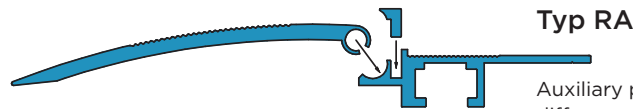

Typ RA

Auxiliary profiles for level differences of approx. 25-40 mm

MFZ 10/1
with aluminum bridging profile

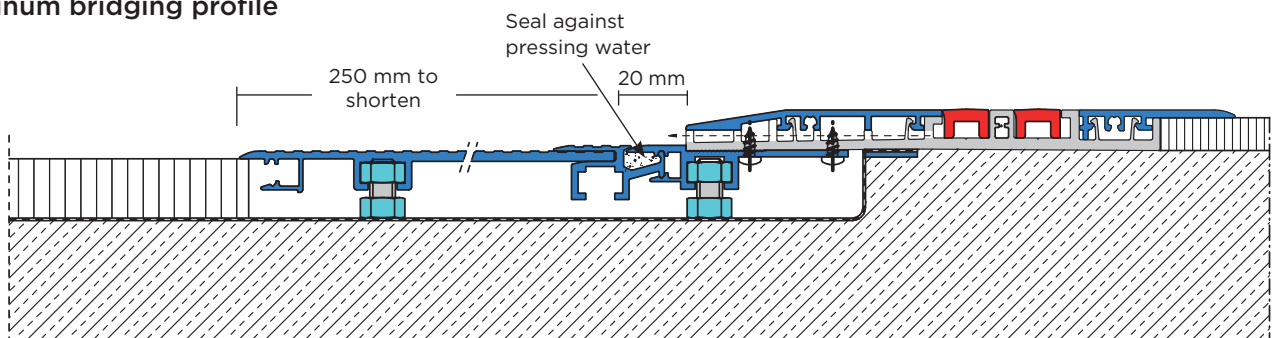

THE ALUMAT MAGNET DOUBLE SEALS

offer security and protection even in old buildings. They eliminate – ideally in conjunction with a new door – optimally in combination with a new door – trip thresholds from the living area to the outside for house, balcony and patio doors. It may also be sufficient to simply replace the threshold.



BEFORE

Door thresholds represent a risk of falling. More than half of the nursing home residents fall at least once a year. Of the over 65s living at home, around one in three falls once a year. (Deutsches Ärzteblatt 2005: A 2150)



AFTER

An optimum, barrier-free transition can be achieved in most old buildings by combining a magnetic double seal with a new door with magnet double seal. Numerous auxiliary profiles also ensure flexible solutions that can be adapted to the structural conditions.

Principles of barrier-free construction according to DIN 18040

- DIN 18025 was replaced as of 9/1/2011 by DIN 18040.
- From DIN 18040: "lower door stops and thresholds are **not permitted**. If they are technically indispensable, they must not be higher than 2 cm. If an outdoor area (terrace, loggia or balcony) is assigned to the flat it must be **barrierfree**. it must be accessible from the flat without thresholds."

